

---

# PRODUCT CATALOGUE

---

# 2019



# CONTENTS

ABOUT THE COMPANY	4
CERTIFICATES OF ECOSOFT	6
ABOUT THE COMPANY	8
<b>ECOSOFT P'URE REVERSE OSMOSIS FILTERS</b>	
Ecosoft P'URE reverse osmosis filter with mineralization	12
Ecosoft P'URE AquaCalcium reverse osmosis filter	13
Pressure booster pump	14
Ecosoft AquaCalcium replacement filter	15
<b>ECOSOFT ABSOLUTE REVERSE OSMOSIS FILTERS</b>	
Ecosoft ABSOLUTE reverse osmosis filter	17
Ecosoft ABSOLUTE reverse osmosis filter with mineralization	18
Ecosoft ABSOLUTE reverse osmosis filter on metal rack with pump	19
<b>ECOSOFT STANDARD REVERSE OSMOSIS FILTERS</b>	
Ecosoft STANDARD reverse osmosis filter	21
Ecosoft STANDARD reverse osmosis filter with mineralization	22
Ecosoft STANDARD reverse osmosis filter with pump	23
Ecosoft STANDARD reverse osmosis filter on metal rack with pump and mineralization filter	24
Ecosoft STANDARD 3-stage filter	25
<b>ECOSOFT SEDIMENT FILTERS</b>	
Ecosoft sediment filter	27
Ecosoft high pressure sediment filter	28
Ecosoft sediment filter for hot water	29
Ecosoft BIG BLUE in-line water filters	30
Ecosoft Aquapoint whole house filter / system	31
Ecosoft SCALEX scale inhibitor	32
<b>PITCHER FILTERS</b>	
Ecosoft DEWBERRY SLIM pitcher filter	34
Ecosoft DEWBERRY SHAPE pitcher filter	34
Replacement filters for Ecosoft DEWBERRY pitcher filters	35
Ecosoft LUNA pitcher filter	36
Ecosoft MAXIMA pitcher filter	36
Replacement filters for Ecosoft pitcher filters	37
Universal replacement filter for pitcher filters	38
MAX replacement filter for pitcher filters	38
<b>REPLACEMENT FILTERS</b>	
Ecosoft sets of replacement filters	40
Consumables for reverse osmosis filters	41
Ecosoft residential reverse osmosis membrane elements	42
Ecosoft granular activated carbon replacement filters	43
Ecosoft carbon block replacement filters	44
Ecosoft replacement filter for hardness reduction	45

Ecosoft replacement filter with ECOMIX® media	45
Ecosoft replacement filters for iron reduction	46
Ecosoft replacement filters for hydrogen sulfide reduction	47
Ecosoft PP sediment replacement filters	48
Ecosoft dual gradient PP sediment replacement filter	49
Ecosoft PP melt blown sediment replacement filters	50
Ecosoft PP melt blown sediment replacement filters with bacteriostatic effect	52
<b>FILTRATION SYSTEMS</b>	
Filter media	55
Ecosoft PREMIUM water softeners	56
Ecosoft STANDARD water softeners	57
Water softening filters Ecosoft FU (DOWEX® HCRS/S)	58
Iron and hardness reduction filters Ecosoft FK (ECOMIX® A)	59
Water softening filters of continuous flow Ecosoft FU TWIN	60
Iron and hardness reduction filters of continuous flow Ecosoft FK TWIN	61
Chlorine reduction filters Ecosoft FPA	62
Hydrogen sulfide reduction filters Ecosoft FPC	63
Sediment filters Ecosoft FP	64
Control valves	64
<b>SOLUTIONS FOR HORECA</b>	
Ecosoft ROburst 1000 reverse osmosis filter	67
Ecosoft ROburst 1500 reverse osmosis filter	68
Ecosoft ROburst PRO reverse osmosis filter	69
Ecosoft ROburst 3000 reverse osmosis filter	70
<b>ECOSOFT COMMERCIAL REVERSE OSMOSIS SYSTEMS</b>	
Ecosoft commercial reverse osmosis system MO 6500	72
Ecosoft commercial reverse osmosis system MO 12000	73
Ecosoft commercial reverse osmosis system MO 24000	74
Ecosoft commercial reverse osmosis system MO 36000	75
Ecosoft dosing pump kits	76
<b>ECOSOFT INDUSTRIAL REVERSE OSMOSIS SYSTEMS</b>	
Industrial reverse osmosis systems	78
RO membranes	79
Cip stations for Ecosoft MO systems	79
Ecosoft RO chemicals	79
Ecosoft UV disinfection units	80
<b>ECOSOFT INDUSTRIAL ULTRAFILTRATION SYSTEMS</b>	
Commercial Ultrafiltration Systems	82
<b>ECOSOFT CONTAINER RO SYSTEMS</b>	
Ecosoft Container RO systems	84
<b>ECOSOFT RO DRINKING WATER VENDING MACHINES</b>	
Ecosoft RO drinking water vending machines	86

We produce water purification filters in Ukraine,  
and sell them to more than 50 countries over the world

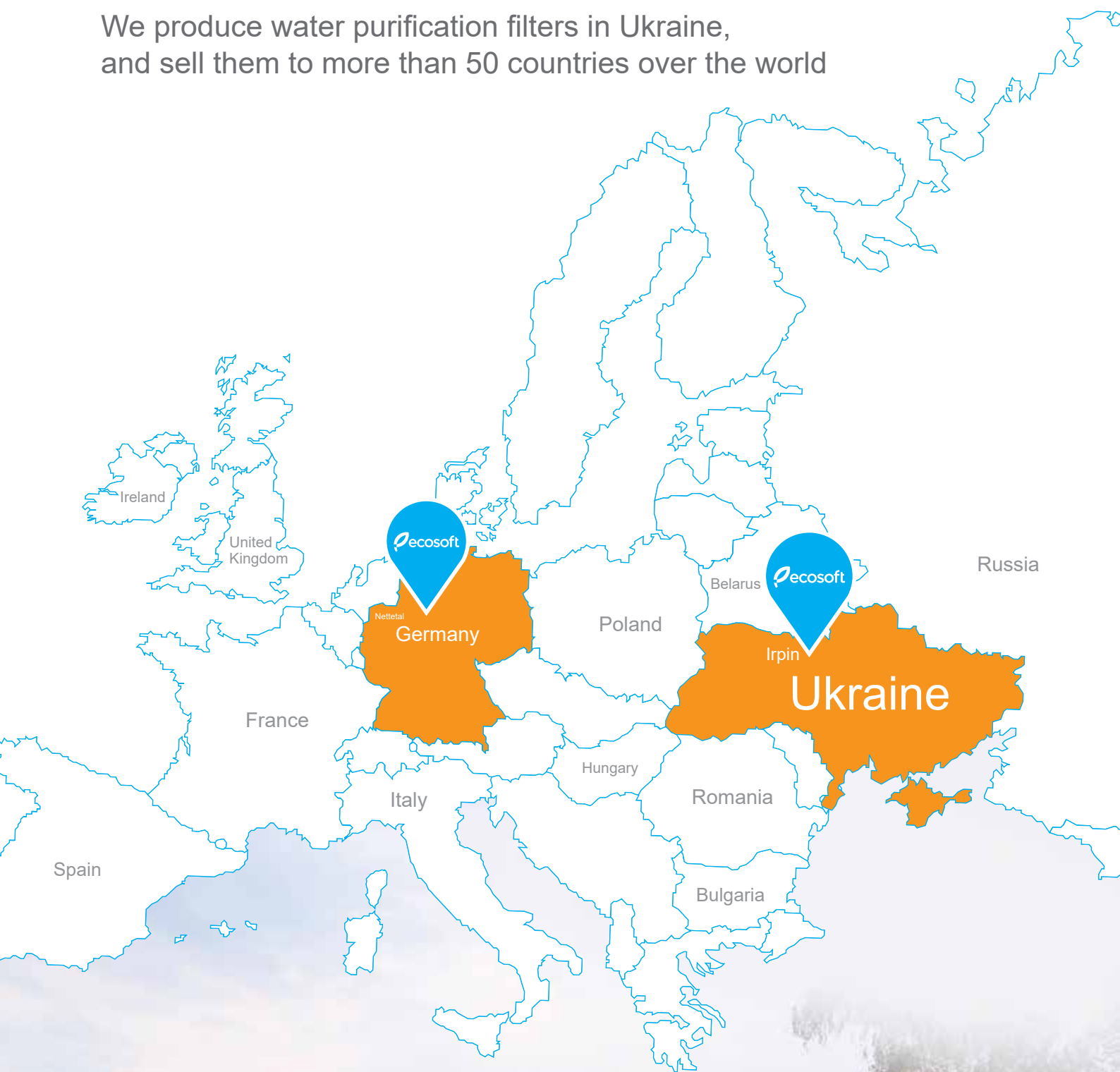



Production and storage facilities over 8,000 sq. m



Own team of highly skilled engineers and designers



Production lines of sediment filters



Production of reverse osmosis and 3-stage filters



Production of vending machines



Production of commercial and industrial reverse osmosis systems



Own workshop section of plastic component production (pitchers, filters housings, brackets, etc.)

**27** years  
of experience

**12**  
production lines

Manufacturing of  
**2 600 000**  
filters per year

Quality is confirmed by the  
**CE, NSF, ISO,**  
**TÜV SÜD**  
certificates

## CERTIFICATES OF ECOSOFT

Ecosoft implemented the best quality management system 5S and the principles of lean manufacturing. That allows us to monitor and improve the products quality.

The excellent quality of Ecosoft products is proved and certified by world organizations TÜV SÜD, ISO, WQA. Ecosoft products meet requirements of the NSF and European Directives.



### Certificate TÜV SÜD

The certificate that guarantees the toxicological safety of Ecomix® filter media. And the water treated with Ecomix® could be used for food



### Gold Seal Certificate from the Water Quality Association (WQA), USA

Ecomix® filter media is certified in accordance with the standards NSF/ANSI 44/61/372.

That means that Ecomix® is safe for use in drinking water. The water treated with Ecomix® is lead-free and the amount of leaching from the product into drinking water is below health-based acceptable levels





### Conformity certificate

Confirms that Ecosoft products meet safety requirements of the European Union.

#### Ecosoft Products:

Advanced water softeners FK  
Water softeners FU  
Chlorine reduction filters FPA  
Sulfide reduction filters FPC  
Sediment filters FP



### Conformity certificate

Confirms that Ecosoft products meet safety requirements of the European Union.

#### Ecosoft Products:

Commercial reverse osmosis systems MO  
Industrial reverse osmosis systems MO



### Conformity certificate

Confirms that Ecosoft products meet safety requirements of the European Union.

#### Ecosoft Products:

RO drinking water vending machines KA



### ISO 9001:2015 certificate

The quality management system for production of water treatment systems, drinking water filters and components, replacement filters, filter media, membranes performed by Ecosoft meet requirements of the State standard ISO 9001:2015



## ECOSOFT IS A STYLISH AND MODERN BRAND

Ecosoft helps partners to open branded stores.

The style of the stores corresponds to the new concept of the company «Power of purity».

That means the maximum open, transparent showcase and store space, cleanliness and ecology colors in the interior: white, shades of blue, green.

**POWER  
OF PURITY**





Ecosoft also provides the function of developing planograms. The products are sold better with the correct supply on the shelf. We know exactly how to present water filters as efficiently as possible and can help to do this.



# ECOSOFT P'URE

Ecosoft P'URE, the innovative line of reverse osmosis filters representing the latest developments in the industry. These premium class filters will provide consumers with safe, pure and tasty drinking water enriched with calcium.



pure

## ECOSOFT P'URE REVERSE OSMOSIS FILTER WITH MINERALIZATION

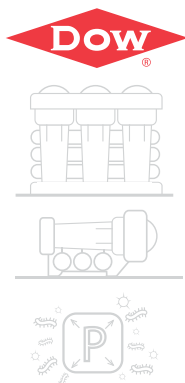

### FILTRATION TECHNOLOGY:

- Sediment PP 5-micron filter
- GAC coconut shell carbon filter
- Carbon block 10-micron filter
- RO membrane element 75 GPD
- Coconut shell carbon filter
- Mineralization filter

### KEY FEATURES:

1. 6 stages of water purification including mineralization
2. Delicious water thanks to DOW Filmtec™ membrane element and high-quality activated carbon filters
3. Possibility of two installation positions: vertical and horizontal
4. 'Clean room' effect — vacuum tightness of the filter since it leaves its assembly line
5. Manufacturer assurance — all systems are tested and approved for domestic application

### SPECIFICATIONS:

Code	Flow capacity, LPD (GPD)	Inlet pressure, bar (psi)	Connections	Total volume of storage tank, L (gal)	Dimensions, H x W x D, mm (in)
MO675MPUREEXP	280 (75)	3–6 (43.5–87)	1/2"	11 (2.9)	310 x 440 x 195 (12.2 x 17.3 x 7.7)

### COMPONENTS:

- Filtration module
- Ecosoft set of pre-filters for reverse osmosis filter
- DOW Filmtec™ membrane element 75 GPD (280 LPD)
- Ecosoft carbon post-filter for reverse osmosis filter
- Ecosoft mineralization filter for reverse osmosis filter
- 2-handle ball valve faucet 'Modern' for purified water and mineralized water
- Metal pressure tank (total vol. 11 L/2.9 gal, effective vol. up to 7 L/1.8 gal) and tank valve
- Feed water adapter, feed valve, drain saddle
- Set of color tubes (5 pc.) for convenient filter installation
- Service wrenches
- User manual

Unit weight (net/gross), kg: 8.75/10.5  
lb: 19.3/23.2

Box dimensions, m: 0.59 x 0.46 x 0.30  
in: 23.2 x 18.1 x 11.8



### ECOSOFT P'URE REVERSE OSMOSIS FILTER WITH MINERALIZATION

Code	Product	List price, EUR	Pieces in box	Boxes on pallet	Pieces on pallet
MO675MPUREEXP	Ecosoft P'URE reverse osmosis filter with mineralization	264.00	1	28	28

Minimum order is 1 pallet of each item



THE MOST  
DELICIOUS WATER  
IN THIS CATALOG

## ECOSOFT P'URE AQUACALCIUM REVERSE OSMOSIS FILTER

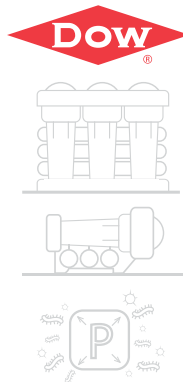

### FILTRATION TECHNOLOGY:

- Sediment PP 5-micron filter
- GAC coconut shell carbon filter
- Carbon block 10-micron filter
- RO membrane element 75 GPD
- AquaCalcium mineralization filter
- Coconut shell carbon post-filter

### KEY FEATURES:

1. Water enriched with calcium by the AquaCalcium mineralization filter
2. Reproduces natural speed of water flowing through mountain rocks
3. Provides stable content of minerals in the purified water — 55–65 mg/L
4. Fresh, soft, and natural taste of water
5. Water with calcium is especially recommended to teenagers and elderly people
6. Manufacturer assurance — all systems are tested and approved for domestic application

### SPECIFICATIONS:

Code	Flow capacity, LPD (GPD)	Inlet pressure, bar (psi)	Connections	Total volume of storage tank, L (gal)	Dimensions, H x W x D, mm (in)
MO675MACPUREEXP	280 (75)	3–6 (43.5–87)	1/2"	11 (2.9)	310 x 440 x 195 (12.2 x 17.3 x 7.7)

### COMPONENTS:

- Filtration module
- Ecosoft set of pre-filters for reverse osmosis filter
- DOW Filmtec™ membrane element 75 GPD (280 L per day)
- Ecosoft carbon post-filter for reverse osmosis filter
- Ecosoft AquaCalcium mineralization filter
- Ball valve faucet 'Modern' for purified water
- Metal pressure tank (total vol. 11 L/2.9 gal, effective vol. up to 7 L/1.8 gal) and tank valve
- Feed water adapter, feed valve, drain saddle
- Set of color tubes (4 pc.) for convenient filter installation
- Service wrenches
- User manual

Unit weight (net/gross), kg: 8.75/10.5

lb: 19.3/23.2

Box dimensions, m: 0.59 x 0.46 x 0.30

in: 23.2 x 18.1 x 11.8



### ECOSOFT P'URE AQUACALCIUM REVERSE OSMOSIS FILTER

Code	Product	List price, EUR	Pieces in box	Boxes on pallet	Pieces on pallet
MO675MACPUREEXP	Ecosoft P'URE AquaCalcium reverse osmosis filter	264.00	1	28	28

Minimum order is 1 pallet of each item



## CONSUMABLES FOR ECOSOFT P'URE REVERSE OSMOSIS FILTERS

### PRESSURE BOOSTER PUMP



#### DESCRIPTION:

Intended for water mains with low pressure.  
The pump will provide the pressure sufficient to push water through the membrane

#### KEY FEATURES:

1. Possibility of installation at any reverse osmosis filter
2. 30...50% of water economy
3. Simple installation — step-by-step installation manual

Unit weight (net/gross), kg: 3.45/3.74  
lb: 7.6/8.3  
Box dimensions, m: 0.35 x 0.18 x 0.12  
in: 13.8 x 7.1 x 4.7

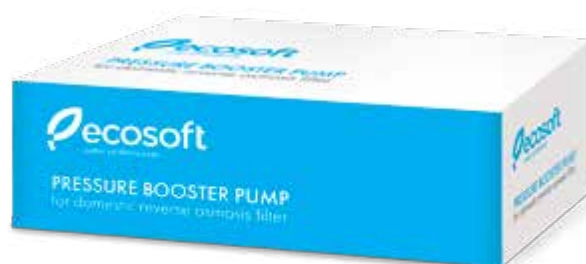

#### PRESSURE BOOSTER PUMP

Code	Product	List price, EUR	Pieces in box	Boxes on pallet	Pieces on pallet
KPOMPROECO	Pressure booster pump for Ecosoft P'URE reverse osmosis filters	117.00	1	108	108

## ECOSOFT AQUACALCIUM REPLACEMENT FILTER



### DESCRIPTION:

The filter with a new mineral composition designed to enrich water with an essential for human organism element such as calcium. It is intended for Ecosoft P'URE AquaCalcium reverse osmosis filters which reproduce natural speed of water flowing through mountain rocks and provide stable content of minerals in the purified water — 55–65 mg/L

### KEY FEATURES:

1. Drinking water enriched with calcium which is vitally important for human health
2. Especially recommended for teenagers and elderly people
3. Fresh, soft, and natural taste of water
4. Calcium reduces risk of osteoporosis, hypertension, stroke, obesity and many other diseases

Unit weight (net/gross), kg: 0.95/0.97  
lb: 2.09/2.14  
Box dimensions, m: 0.38 x 0.33 x 0.15  
in: 15.0 x 13.0 x 6.0



Please be aware it is possible to employ the filter in the other models of Ecosoft filters, or filters produced by different manufacturers. But in this case, saturation of water will be 3-5 times lower

### ECOSOFT AQUACALCIUM REPLACEMENT FILTER ECOSOFT P'URE REVERSE OSMOSIS FILTERS

Code	Product	List price, EUR	Pieces in box	Boxes on pallet	Pieces on pallet
PD2010MACPURE	Ecosoft AquaCalcium replacement filter for Ecosoft P'URE reverse osmosis filters	23.00	4	66	264



# ABSOLUTE

Ecosoft ABSOLUTE, the classical reverse osmosis filters with components of the world's best producers in the industry. Each completed with the DOW Filmtec™ reverse osmosis membrane, stylish 'Modern' faucet and metal tank for purified water.

# ECOSOFT ABSOLUTE REVERSE OSMOSIS FILTER



## FILTRATION TECHNOLOGY:

- Sediment PP 5-micron filter
- GAC coconut shell carbon filter
- CTO coconut shell carbon 10-micron filter
- RO membrane 50 GPD
- Coconut shell carbon post-filter

## KEY FEATURES:

1. 5 stages of water purification
2. 7.9 L/2.1 gal of drinking water per hour
3. Delicious water thanks to DOW Filmtec™ membrane element and high-quality activated carbon filters
4. Filter housing made of pure European food grade plastic
5. Up to 7 L/1.8 gal metal storage tank
6. Manufacturer assurance — all systems are tested and approved for domestic application

## SPECIFICATIONS:

Code	Flow capacity, LPD (GPD)	Inlet pressure, bar (psi)	Connections	Total volume of storage tank, L (gal)	Dimensions, H x W x D, mm (in)
MO550ECOEXP	190 (50)	3–6 (43.5–87)	1/2"	11 (2.9)	420 x 410 x 150 (16.5 x 16.1 x 5.9)

## COMPONENTS:

- Filtration module
- Ecosoft set of pre-filters for reverse osmosis filter
- DOW Filmtec™ membrane element 50 GPD (190 LPD)
- Ecosoft carbon post-filter for reverse osmosis filter
- Stylish ball valve faucet 'Modern' for purified water
- Metal pressure tank (total vol. 11 L/2.9 gal, effective vol. up to 7 L/1.8 gal) and tank valve
- Feed water adapter, feed valve, drain saddle
- Set of color tubes (4 pc.) for convenient filter installation
- Service wrench
- User manual

Unit weight (net/gross), kg: 7.00/8.75  
lb: 15.4/19.3  
Box dimensions, m: 0.29 x 0.58 x 0.47  
in: 11.4 x 22.8 x 18.5



## ECOSOFT ABSOLUTE REVERSE OSMOSIS FILTER

Code	Product	List price, EUR	Pieces in box	Boxes on pallet	Pieces on pallet
MO550ECOEXP	Ecosoft ABSOLUTE reverse osmosis filter	251.00	1	28	28

Minimum order is 1 pallet of each item

## ECOSOFT ABSOLUTE REVERSE OSMOSIS FILTER WITH MINERALIZATION



### FILTRATION TECHNOLOGY:

- Sediment PP 5-micron filter
- GAC coconut shell carbon filter
- CTO coconut shell carbon 10-micron filter
- RO membrane 50 GPD
- Coconut shell carbon post-filter
- Mineralization filter

### KEY FEATURES:

1. 6 stages of water purification including mineralization
2. 7.9 L/2.1 gal of drinking water per hour
3. Delicious water thanks to DOW Filmtec™ membrane element and high-quality activated carbon filters
4. Filter housing made of pure European food grade plastic
5. Up to 7 L/1.8 gal metal storage tank
6. Manufacturer assurance — all systems are tested and approved for domestic application

### SPECIFICATIONS:

Code	Flow capacity, LPD (GPD)	Inlet pressure, bar (psi)	Connections	Total volume of storage tank, L (gal)	Dimensions, H x W x D, mm (in)
MO650MECOEXP	190 (50)	3–6 (43.5–87)	1/2"	11 (2.9)	420 x 410 x 150 (16.5 x 16.1 x 5.9)

### COMPONENTS:

- Filtration module
- Ecosoft set of pre-filters for reverse osmosis filter
- DOW Filmtec™ membrane element 50 GPD (190 LPD)
- Ecosoft carbon post-filter for reverse osmosis filter
- Ecosoft mineralization filter for reverse osmosis filter
- Double stylish ball valve faucet 'Modern' for purified and mineralized water
- Metal pressure tank (total vol. 11 L/2.9 gal, effective vol. up to 7 L/1.8 gal) and tank valve
- Feed water adapter, feed valve, drain saddle
- Set of color tubes (5 pc.) for convenient filter installation
- Service wrench
- User manual

Unit weight (net/gross), kg: 7.85/9.6

lb: 17.3/21.2

Box dimensions, m: 0.29 x 0.58 x 0.47

in: 11.4 x 22.8 x 18.5



### ECOSOFT ABSOLUTE REVERSE OSMOSIS FILTER WITH MINERALIZATION

Code	Product	List price, EUR	Pieces in box	Boxes on pallet	Pieces on pallet
MO650MECOEXP	<b>Ecosoft ABSOLUTE reverse osmosis filter with mineralization</b>	269.00	1	28	28

Minimum order is 1 pallet of each item



# ECOSOFT ABSOLUTE REVERSE OSMOSIS FILTER ON METAL RACK WITH PUMP



## FILTRATION TECHNOLOGY:

- Sediment PP 5-micron filter
- GAC coconut shell carbon filter
- CTO coconut shell carbon 10-micron filter
- RO membrane 50 GPD
- Coconut shell carbon post-filter

## KEY FEATURES:

1. Designed for water supply systems with low pressure
2. The filter is stable and simple in maintenance thanks to the metal rack
3. 5 stages of water purification
4. 7.9 L/2.1 gal of drinking water per hour
5. Delicious water thanks to DOW Filmtec™ membrane element and high-quality activated carbon filters
6. Filter housing made of pure European food grade plastic
7. Up to 7 L/1.8 gal metal storage tank
8. Manufacturer assurance — all systems are tested and approved for domestic application

## SPECIFICATIONS:

Code	Flow capacity, LPD (GPD)	Inlet pressure, bar (psi)	Connections	Total volume of storage tank, L (gal)	Dimensions, H x W x D, mm (in)
MO550PSECOEXP	190 (50)	2–5 (29.0–72.5)	1/2"	11 (2.9)	485 x 410 x 195 (19.1 x 16.1 x 7.7)

## COMPONENTS:

- Filtration module with domestic pump on metal rack
- Ecosoft set of pre-filters for reverse osmosis filter
- DOW Filmtec™ membrane element 50 GPD (190 LPD)
- Ecosoft carbon post-filter for reverse osmosis filter
- Stylish ball valve faucet 'Modern' for purified water
- Metal pressure tank (total vol. 11 L/2.9 gal, effective vol. up to 7 L/1.8 gal) and tank valve
- Feed water adapter, feed valve, drain saddle
- Set of color tubes (4 pc.) for convenient filter installation
- Service wrench
- User manual

Unit weight (net/gross), kg: 11.95/3.70

lb: 26.6/30.2

Box dimensions, m: 0.59 x 0.46 x 0.30

in: 23.2 x 18.1 x 11.8



## ECOSOFT ABSOLUTE REVERSE OSMOSIS FILTER ON METAL RACK WITH PUMP

Code	Product	List price, EUR	Pieces in box	Boxes on pallet	Pieces on pallet
MO550PSECOEXP	Ecosoft ABSOLUTE reverse osmosis filter on metal rack with pump	334.00	1	28	28

Minimum order is 1 pallet of each item



# STANDARD

Ecosoft STANDARD, the most affordable line of reverse osmosis filters.

The key components of the filter are the Ecosoft reverse osmosis membrane, standard faucet and plastic tank for purified water.

# ECOSOFT STANDARD REVERSE OSMOSIS FILTER



## FILTRATION TECHNOLOGY:

- Sediment PP 5-micron filter
- GAC coconut shell carbon filter
- Sediment PP 1-micron filter
- RO membrane element 50 GPD
- Coconut shell carbon post-filter

## KEY FEATURES:

1. 5 stages of water purification
2. 7.9 L/2.1 gal of drinking water per hour
3. Ecosoft membrane element
4. Delicious taste of water thanks to coconut shell carbon filter
5. Filter housing made of pure European food grade plastic
6. Manufacturer assurance — all systems are tested and approved for domestic application

## SPECIFICATIONS:

Code	Flow capacity, LPD (GPD)	Inlet pressure, bar (psi)	Connections	Total volume of storage tank, L (gal)	Dimensions, H x W x D, mm (in)
MO550ECOST	190 (50)	3–6 (43.5–87)	1/2"	12 (3.2)	420 x 410 x 150 (16.5 x 16.1 x 5.9)

## COMPONENTS:

- Filtration module
- Ecosoft set of pre-filters for reverse osmosis filter
- Ecosoft membrane element 50 GPD (190 LPD)
- Ecosoft carbon post-filter for reverse osmosis filter
- Chrome ball valve faucet for purified water
- Plastic pressure tank (total vol. 12 L/3.2 gal, effective vol. up to 7 L/1.8 gal) and tank valve
- Feed water adapter, feed valve, drain saddle
- Set of color tubes (4 pc.) for convenient filter installation
- Service wrench
- User manual

Unit weight (net/gross), kg: 7.00/8.75

lb: 15.4/19.3

Box dimensions, m: 0.29 x 0.58 x 0.47

in: 11.4 x 22.8 x 18.5



## ECOSOFT STANDARD REVERSE OSMOSIS FILTER

Code	Product	List price, EUR	Pieces in box	Boxes on pallet	Pieces on pallet
MO550ECOST	Ecosoft STANDARD reverse osmosis filter	179.00	1	28	28

Minimum order is 1 pallet of each item

## ECOSOFT STANDARD REVERSE OSMOSIS FILTER WITH MINERALIZATION



### FILTRATION TECHNOLOGY:

- Sediment PP 5-micron filter
- GAC coconut shell carbon filter
- Sediment PP 1-micron filter
- RO membrane 50 GPD
- Coconut shell carbon filter
- Mineralization post-filter

### KEY FEATURES:

1. 6 stages of water purification including mineralization
2. 7.9 L/2.1 gal of drinking water per hour
3. Ecosoft membrane element
4. Delicious taste of water thanks to coconut shell carbon filter
5. Filter housing made of pure European food grade plastic
6. Manufacturer assurance — all systems are tested and approved for domestic application

### SPECIFICATIONS:

Code	Flow capacity, LPD (GPD)	Inlet pressure, bar (psi)	Connections	Total volume of storage tank, L (gal)	Dimensions, H x W x D, mm (in)
MO650MECOST	190 (50)	3–6 (43.5–87)	1/2"	12 (3.2)	420 x 410 x 150 (16.5 x 16.1 x 5.9)

### COMPONENTS:

- Filtration module
- Ecosoft set of pre-filters for reverse osmosis filter
- Ecosoft membrane element 50 GPD (190 LPD)
- Ecosoft carbon post-filter for reverse osmosis filter
- Ecosoft mineralization filter for reverse osmosis filter
- Chrome ball valve faucet for purified water
- Plastic pressure tank (total vol. 12 L/3.2 gal, effective vol. up to 7 L/1.8 gal) and tank valve
- Feed water adapter, feed valve, drain saddle
- Set of color tubes (4 pc.) for convenient filter installation
- Service wrench
- User manual

Unit weight (net/gross), kg: 7.00/8.75  
lb: 15.4/19.3

Box dimensions, m: 0.29 x 0.58 x 0.47  
in: 11.4 x 22.8 x 18.5



### ECOSOFT STANDARD REVERSE OSMOSIS FILTER WITH MINERALIZATION

Code	Product	List price, EUR	Pieces in box	Boxes on pallet	Pieces on pallet
MO650MECOST	<b>Ecosoft STANDARD reverse osmosis filter with mineralization</b>	198.00	1	28	28

# ECOSOFT STANDARD REVERSE OSMOSIS FILTER WITH PUMP



## FILTRATION TECHNOLOGY:

- Sediment PP 5-micron filter
- GAC coconut shell carbon filter
- Sediment PP 1-micron filter
- RO membrane element 50 GPD
- Coconut shell carbon post-filter

## KEY FEATURES:

1. Designed for water supply systems with low pressure
2. 5 stages of water purification
3. 7.9 L/2.1 gal of drinking water per hour
4. Ecosoft membrane element
5. Delicious taste of water thanks to coconut shell carbon filter
6. Filter housing made of pure European food grade plastic
7. Manufacturer assurance — all systems are tested and approved for domestic application

## SPECIFICATIONS:

Code	Flow capacity, LPD (GPD)	Inlet pressure, bar (psi)	Connections	Total volume of storage tank, L (gal)	Dimensions, H x W x D, mm (in)
MO550PECOST	190 (50)	2–5 (29.0–72.5)	1/2"	12 (3.2)	455 x 410 x 195 (17.9 x 16.1 x 7.7)

## COMPONENTS:

- Filtration module with pump
- Ecosoft set of pre-filters for reverse osmosis filter
- Ecosoft membrane element 50 GPD (190 LPD)
- Ecosoft carbon post-filter for reverse osmosis filter
- Chrome ball valve faucet for purified water
- Plastic pressure tank (total vol. 12 L/3.2 gal, effective vol. up to 7 L/1.8 gal) and tank valve
- Feed water adapter, feed valve, drain saddle
- Set of color tubes (4 pc.) for convenient filter installation
- Service wrench
- User manual

Unit weight (net/gross), kg: 10.48/12.23

lb: 23.1/26.96

Box dimensions, m: 0.59 x 0.46 x 0.30

in: 23.2 x 18.1 x 11.8



## ECOSOFT STANDARD REVERSE OSMOSIS FILTER WITH PUMP

Code	Product	List price, EUR	Pieces in box	Boxes on pallet	Pieces on pallet
MO550PECOST*	Ecosoft STANDARD reverse osmosis filter with pump	289.00	1	28	28

\* Please use MO550PECOUK code for UK plug or MO550PECOUS code for US plug

Minimum order is 1 pallet of each item



## ECOSOFT STANDARD REVERSE OSMOSIS FILTER ON METAL RACK WITH PUMP AND MINERALIZATION FILTER



### FILTRATION TECHNOLOGY:

- Sediment PP 5-micron filter
- GAC coconut shell carbon filter
- Sediment PP 1-micron filter
- RO membrane element 50 GPD
- Coconut shell carbon post-filter
- Mineralization filter

### KEY FEATURES:

1. Designed for water supply systems with low pressure
2. The filter is stable and simple in maintenance thanks to the metal rack
3. 6 stages of water purification including mineralization
4. 7.9 L/2.1 gal of drinking water per hour
5. Ecosoft membrane element
6. Delicious taste of water thanks to coconut shell carbon filter
7. Filter housing made of pure European food grade plastic
8. Manufacturer assurance — all systems are tested and approved for domestic application

### SPECIFICATIONS:

Code	Flow capacity, LPD (GPD)	Inlet pressure, bar (psi)	Connections	Total volume of storage tank, L (gal)	Dimensions, H x W x D, mm (in)
MO650M1PSECOST	190 (50)	2–5 (29.0–72.5)	1/2"	12 (3.2)	485 x 410 x 195 (19.1 x 16.1 x 7.7)

### COMPONENTS:

- Filtration module with domestic pump on metal rack
- Ecosoft set of pre-filters for reverse osmosis filter
- Ecosoft membrane element 50 GPD (190 LPD)
- Ecosoft carbon post-filter for reverse osmosis filter
- Ecosoft mineralization filter for reverse osmosis filter
- Chrome ball valve faucet for purified water
- Plastic pressure tank (total vol. 12 L/3.2 gal, effective vol. up to 7 L/1.8 gal) and tank valve
- Feed water adapter, feed valve, drain saddle
- Set of color tubes (4 pc.) for convenient filter installation
- Service wrench
- User manual

Unit weight (net/gross), kg: 11.95/13.70  
lb: 26.6/30.2

Box dimensions, m: 0.59 x 0.46 x 0.30  
in: 23.2 x 18.1 x 11.8



### ECOSOFT STANDARD REVERSE OSMOSIS FILTER ON METAL RACK WITH PUMP AND MINERALIZATION FILTER

Code	Product	List price, EUR	Pieces in box	Boxes on pallet	Pieces on pallet
MO650M1PSECOST*	<b>Ecosoft STANDARD reverse osmosis filter on metal rack with pump and mineralization filter</b>	320.00	1	28	28

\* Please use MO650M1PSUK code for UK plug or MO650M1PSUS code for US plug

Minimum order is 1 pallet of each item

# ECOSOFT STANDARD 3-STAGE FILTER



## FILTRATION TECHNOLOGY:

- 5-micron PP melt blown sediment filter — reduces content of sand, silt, scale and other insoluble compounds
- Filter with ECOMIX® D37 advanced softening material — reduces hardness, chlorine, and concentration of toxic heavy metals
- CTO coconut shell carbon filter — reduces content of chlorination by-products and sediments

## KEY FEATURES:

1. 24/7/365 source of drinking water
2. 3 stages of tap water purification with unique ECOMIX® technology
3. Simple installation and replacement of filters
4. Compact dimensions
5. Filter housing made of pure European food grade plastic

## SPECIFICATIONS:

Code	Flow capacity, L/min (gpm)	Inlet pressure, bar (psi)	Connections	Dimensions, H x W x D, mm (in)
FMV3ECOEXP	1.0 (0.25)	2–6 (29–87)	1/2"	420 x 370 x 150 (16.5 x 14.6 x 5.9)

## COMPONENTS:

- Filtration module
- Set of replacement filters
- Chrome ball valve faucet for purified water
- Feed water adapter, feed valve
- Set of color tubes (2 pc.) for convenient filter installation
- Service wrench
- User manual



Unit weight (net/gross), kg: 4.00/4.15

lb: 8.82/9.15

Box dimensions, m: 0.49 x 0.41 x 0.38

in: 19.3 x 16.1 x 15.0

## ECOSOFT STANDARD 3-STAGE FILTER

Code	Product	List price, EUR	Pieces in box	Boxes on pallet	Pieces on pallet
FMV3ECOEXP	Ecosoft STANDARD 3-stage filter	72.00	3	20	60

Minimum order is 1 pallet of each item

# ECOSOFT SEDIMENT FILTERS

Sediment filters are intended for purification of water for household purposes from various sediments.

The filters effectively reduce content of sand, silt, rust, scale and other insoluble impurities of tap, well and borehole water.

# ECOSOFT SEDIMENT FILTER



## DESCRIPTION:

Perfect for apartments with 1 bathroom.

Transparent housing to control when the filter needs to be replaced. Connection to plumbing is performed with brass bushings

## KEY FEATURES:

1. Affordable price for excellent quality from the Ukrainian manufacturer
2. Filter housing made of pure European first grade plastic
3. Protection of sanitary ware and plumbing
4. Compact and easy to install

## SPECIFICATIONS:

	FPV12ECOEXP	FPV34ECOEXP
Standard size	2.5" × 10"	
Connection size	1/2"	3/4"
Maximum flow capacity	10 L/min (2.5 gpm)	
Operating pressure	3.5–4 bar (50–60 psi)	
Maximum pressure	6 bar (87 psi)	
Water temperature	+3...+43 °C (37...109 °F)	

## COMPONENTS:

- Filter housing
- 5-micron PP melt blown sediment filter
- Bracket
- Service wrench
- Screws
- User manual



## ECOSOFT SEDIMENT FILTERS

Code	Product	List price, EUR	Pieces in box	Boxes on pallet	Pieces on pallet
FPV12ECOEXP	<b>1/2" Ecosoft Sediment Filter</b> Individual carton box, colour packing Unit weight (net/gross), kg: 1.0/1.05 (lb: 2.2/2.31) Box dimensions, m: 0.58 x 0.45 x 0.39 (in: 22.8 x 17.7 x 15.4)	15.00	12	20	240
FPV34ECOEXP	<b>3/4" Ecosoft Sediment Filter</b> Individual carton box, colour packing Unit weight (net/gross), kg: 1.0/1.05 (lb: 2.2/2.31) Box dimensions, m: 0.58 x 0.45 x 0.39 (in: 22.8 x 17.7 x 15.4)	15.00	12	20	240
FPV12ECOST	<b>1/2" Ecosoft Sediment Filter Housing</b> Without individual carton box Unit weight (net/gross), kg: 0.97/0.97 (lb: 2.1/2.1) Box dimensions, m: 0.46 x 0.27 x 0.37 (in: 18.1 x 10.6 x 14.6)	13.00	6	40	240
FPV34ECOST	<b>3/4" Ecosoft Sediment Filter Housing</b> Without individual carton box Unit weight (net/gross), kg: 0.97/0.97 (lb: 2.1/2.1) Box dimensions, m: 0.46 x 0.27 x 0.37 (in: 18.1 x 10.6 x 14.6)	13.00	6	40	240

Minimum order is 1 pallet of each item

## ECOSOFT HIGH-PRESSURE SEDIMENT FILTER



### DESCRIPTION:

Perfect for apartments with 1 bathroom. Capable to operate at high pressure. Connection to plumbing is performed with brass bushings

### KEY FEATURES:

1. Affordable price for excellent quality from the Ukrainian manufacturer
2. Maximum pressure 30 bar
3. Filter housing made of pure European first grade plastic
4. Protection of sanitary ware and plumbing
5. Compact and easy to install

### SPECIFICATIONS:

	FPV12PECOEXP	FPV34PECOEXP
Standard size	2.5" × 10"	
Connection size	1/2"	3/4"
Maximum flow capacity	10 L/min (2.5 gpm)	
Operating pressure	3.5–4 bar (50–60 psi)	
Maximum pressure	30 bar (435 psi)	
Water temperature	+3...+43 °C (37...109 °F)	

### COMPONENTS:

- Filter housing
- 5-micron PP melt blown sediment filter
- Bracket
- Service wrench
- Screws
- User manual



### ECOSOFT HIGH-PRESSURE SEDIMENT FILTERS

Code	Product	List price, EUR	Pieces in box	Boxes on pallet	Pieces on pallet
FPV12PECOEXP	<b>1/2" Ecosoft High-Pressure Sediment Filter</b>				
	Individual carton box, colour packing				
	Unit weight (net/gross), kg: 1.0/1.05 lb: 2.2/2.31	12.00	12	20	240
	Box dimensions, m: 0.58 x 0.45 x 0.39 in: 22.8 x 17.7 x 15.4				
FPV34PECOEXP	<b>3/4" Ecosoft High-Pressure Sediment Filter</b>				
	Individual carton box, colour packing				
	Unit weight (net/gross), kg: 1.0/1.05 lb: 2.2/2.31	12.00	12	20	240
	Box dimensions, m: 0.58 x 0.45 x 0.39 in: 22.8 x 17.7 x 15.4				

Minimum order is 1 pallet of each item



# ECOSOFT SEDIMENT FILTER FOR HOT WATER



## DESCRIPTION:

Perfect for apartments with 1 bathroom.

Connection to plumbing is performed with brass bushings

## KEY FEATURES:

1. Affordable price for excellent quality from the Ukrainian manufacturer
2. Filter housing made of glass-filled polypropylene, optimal for hot water
3. Filter housing made of pure European first grade plastic
4. Protection of sanitary ware and plumbing
5. Compact and easy to install

## SPECIFICATIONS:

	FPV12HWECEOEXP	FPV34HWECEOEXP
Standard size	2.5" x 10"	
Connection size	1/2"	3/4"
Maximum flow capacity	10 L/min (2.5 gpm)	
Operating pressure	3.5–4 bar (50–60 psi)	
Maximum pressure	8.6 bar (125 psi)	
Water temperature	+3...+80 °C (37...176 °F)	

## COMPONENTS:

- Filter housing
- 5-micron PP melt blown sediment filter
- Bracket
- Service wrench
- Screws
- User manual



## ECOSOFT SEDIMENT FILTERS FOR HOT WATER

Code	Product	List price, EUR	Pieces in box	Boxes on pallet	Pieces on pallet
FPV12HWECEOEXP	<b>1/2" Ecosoft Sediment Filter for Hot Water</b>				
	Individual carton box, colour packing				
	Unit weight (net/gross), kg: 1.0/1.05 lb: 2.2/2.31	21.00	12	20	240
	Box dimensions, m: 0.58 x 0.45 x 0.39 in: 22.8 x 17.7 x 15.4				
FPV34HWECEOEXP	<b>3/4" Ecosoft Sediment Filter for Hot Water</b>				
	Individual carton box, colour packing				
	Unit weight (net/gross), kg: 1.0/1.05 lb: 2.2/2.31	21.00	12	20	240
	Box dimensions, m: 0.58 x 0.45 x 0.39 in: 22.8 x 17.7 x 15.4				

Minimum order is 1 pallet of each item

## ECOSOFT BIG BLUE IN-LINE WATER FILTERS



### DESCRIPTION:

Perfect for apartments and private houses with 1-3 bathrooms. With the filter, you can employ the replacement filter appropriate specifically for your water condition

### KEY FEATURES:

1. High effectiveness of water purification
2. Made of high-quality and durable components
3. Protection of sanitary ware and plumbing
4. Manufacturing certified in accordance with ISO 9001:2015

### SPECIFICATIONS:

	FPV4510ECOEXP	FPV4520ECOEXP
Standard size	4.5" x 10"	4.5" x 20"
Connection size	1"	
Maximum flow capacity	50 L/min (13 gpm)	83 L/min (22 gpm)
Operating pressure	3.5–6 bar (50–87 psi)	
Maximum pressure	8 bar (116 psi)	
Water temperature	+3...+43 °C (37...109 °F)	

### COMPONENTS:

- Filter housing
- Bracket
- Service wrench
- Screws
- User manual

### ECOSOFT BIG BLUE IN-LINE WATER FILTERS

Code	Product	List price, EUR	Pieces in box	Boxes on pallet	Pieces on pallet
FPV4510ECOEXP	<b>Ecosoft BB10 in-line water filter</b>	68.00	6	12	72
	Unit weight (net/gross), kg: 3.00/ 3.45 lb: 6.61/7.61 Box dimensions, m: 0.41 x 0.41 x 0.65 in: 16.1 x 16.1 x 25.6				
FPV4520ECOEXP	<b>Ecosoft BB20 in-line water filter</b>	82.00	4	12	48
	Unit weight (net/gross), kg: 4.00/4.45 lb: 8.82/9.81 Box dimensions, m: 0.61 x 0.41 x 0.39 in: 24.0 x 16.1 x 15.4				

Minimum order is 1 pallet of each item

# ECOSOFT AQUAPOINT WHOLE HOUSE FILTER / SYSTEM

## APPLICATION:

The ideal choice for apartments, private houses, small restaurants

## KEY FEATURES:

- Compact design
- Standard replacement BB20 filters
- Six ready-made solutions for different water problems
- Filter can be easily complemented with softener or advanced softener
- Easy connection from any side of filter
- Can be installed on the floor or hung on the wall



## 6 SOLUTIONS FOR DIFFERENT WATER PROBLEMS

	BB20 CARTRIDGE IN	BB20 CARTRIDGE OUT
<b>SAND &amp; RUST</b>	<b>PP20</b> 20 µm melt blown polypropylene sediment replacement filter	<b>PP5</b> 5 µm melt blown polypropylene sediment replacement filter
<b>CHLORINE</b>	<b>PP20</b> 20 µm melt blown polypropylene sediment replacement filter	<b>GAC</b> Granular activated carbon replacement filter
<b>COLOR AND CHLORINE</b>	<b>GAC</b> Granular activated carbon replacement filter	<b>CTO10</b> Carbon block replacement filter
<b>H<sub>2</sub>S (ROTTEN EGGS SMELL)</b>	<b>PP20</b> 20 µm melt blown polypropylene sediment replacement filter	<b>GAC-CAT</b> Smell reducing replacement filter with catalytic activated carbon
<b>IRON</b>	<b>PP20</b> 20 µm melt blown polypropylene sediment replacement filter	<b>FERROMIX</b> Iron reducing replacement filter
<b>IRON &amp; H<sub>2</sub>S</b>	<b>FERROMIX</b> Iron reducing replacement filter	<b>GAC-CAT</b> Smell reducing replacement filter with catalytic activated carbon

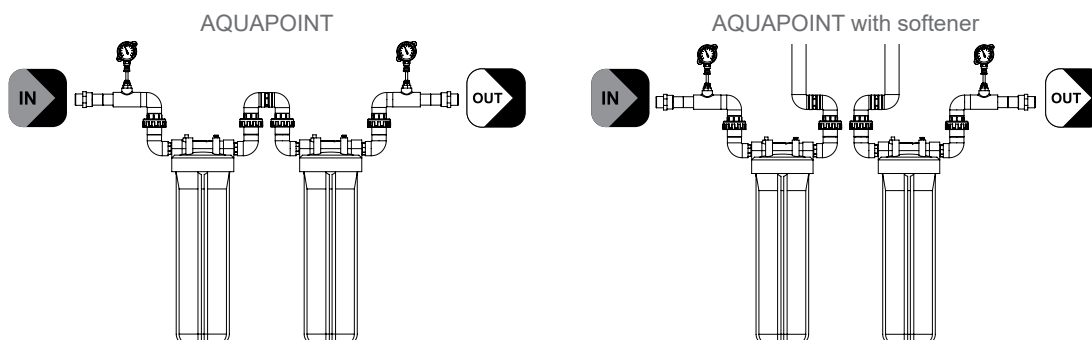

## SPECIFICATIONS:

Code	Maximum flow capacity L/min (gpm)	Operating pressure, bar (psi)	Maximum pressure, bar (psi)	Water temperature, °C (°F)	Dimensions, H x W x D, mm (in)
FPV24520ECOEXP	83 (22)	3–5 (43–72)	8 (116)	+5...+35 (41...95)	900 × 550 × 300 (35.4 × 21.7 × 11.8)

## COMPONENTS:

- AQUAPOINT whole house filter
- Service wrench
- User manual
- **No cartridges inside**

## ECOSOFT AQUAPOINT WHOLE HOUSE FILTER / SYSTEM

Code	Product	List price, EUR	Pieces in box	Boxes on pallet	Pieces on pallet
FPV24520ECO	Ecosoft Aquapoint whole house filter / system	590.00	1	12	12

## ECOSOFT SCALEX SCALE INHIBITOR



### APPLICATION:

scale prevention for water heaters, washing machines and dishwashers

### DESCRIPTION:

innovative and eco-friendly scale inhibitor

### KEY FEATURES:

1. FREE OF PHOSPHATES & POLYPHOSPHATES
2. Capacity of 20 000 L (5 300 gal)
3. High operating temperature of heated water up to 105 °C (221 °F)
4. Reduces energy consumption
5. Safe for human health and environment



### UNIQUE SCALE INHIBITOR

Innovative and eco-friendly filter media with complex effect on hardness, which prevents scale formation on heating elements of household appliances

### SPECIFICATIONS:

Code	Application	Service life, L (gal)	Operating water temperature, °C (°F)	Operating pressure, bar (psi)
<b>FOSE100ECOEXP</b>	Washing machines and dishwashers	20 000 (5 300)	+3...+43 °C (37...109 °F)	6 (87)
<b>FOSE200ECOEXP</b>	Water heaters	20 000 (5 300)		

### SCALEX SCALE INHIBITOR

Code	Product	List price, EUR	Pieces in box	Boxes on pallet	Pieces on pallet
FOSE100ECOEXP	<b>SCALEX inline scale inhibitor for washing machines and dishwashers</b> Unit weight (net/gross), kg: 0.16/0.17 (lb: 0.35/0.37) Box dimensions, m: 0.43 x 0.31 x 0.30 (in: 16.9 x 12.2 x 11.8)	9.00	48	72	3 456
PSE200ECOEXP	<b>SCALEX scale inhibitor filter media for washing machines and dishwashers</b> <b>Filler volume: 200 ml (6.8 oz) – for 2 replacements</b> Unit weight (net/gross), kg: 0.12/0.13 (lb: 0.26/0.29) Box dimensions, m: 0.32 x 0.24 x 0.27 (in: 12.6 x 9.4 x 10.6)	6.00	36	84	3 024
FOSE200ECOEXP	<b>SCALEX inline scale inhibitor for water heaters</b> Unit weight (net/gross), kg: 0.49/0.52 (lb: 1.1/1.2) Box dimensions, m: 0.37 x 0.33 x 0.46 (in: 14.6 x 13.0 x 18.1)	22.00	18	36	648
PSE2005ECOEXP	<b>SCALEX scale inhibitor replacement filter for water heaters</b> Unit weight (net/gross), kg: 0.10/0.11 (lb: 0.22/0.24) Box dimensions, m: 0.32 x 0.24 x 0.27 (in: 12.6 x 9.4 x 10.6)	15.00	24	84	2 016

Minimum order is 1 pallet of each item



# Dewberry

ECOSOFT DEWBERRY

The easiest way to get pure and tasty water at your kitchen.



## ECOSOFT DEWBERRY SLIM PITCHER FILTER



### DESCRIPTION:

An elegant rectangular shape with design thin lines

Total volume — 3.5 L

Purified water volume — 1.7 L

### KEY FEATURES:

1. Fits into the door of refrigerator
2. Flip for easy water pouring
3. Spout to protect pure water from dust
4. Silicon base for extra immobility
5. Convenient ergonomic handle

## ECOSOFT DEWBERRY SHAPE PITCHER FILTER



### DESCRIPTION:

An elegant round shape with harmonious soft lines

Total volume — 3.5 L

Purified water volume — 2 L

### KEY FEATURES:

1. Flip for easy water pouring
2. Spout to protect pure water from dust
3. Non-slip base for extra immobility
4. Convenient ergonomic handle

### ECOSOFT DEWBERRY PITCHER FILTERS

Code	Product	List price, EUR	Pieces in box	Boxes on pallet	Pieces on pallet
FMVSLIMB	<b>Ecosoft DEWBERRY SLIM pitcher filter</b>				
	Unit weight (net/gross), kg: 1.1/1.23 lb: 2.4/2.7	25.00	4	42	168
	Box dimensions, m: 0.52 x 0.34 x 0.28 in: 20.5 x 13.4 x 11.0				
FMVSHAPER	<b>Ecosoft DEWBERRY SHAPE pitcher filter</b>				
	Unit weight (net/gross), kg: 1.1/1.2 lb: 2.4/2.6	22.00	4	42	168
	Box dimensions, m: 0.52 x 0.34 x 0.28 in: 20.5 x 13.4 x 11.0				

## REPLACEMENT FILTER FOR ECOSOFT DEWBERRY PITCHER FILTERS

## DESCRIPTION:

Intended for DEWBERRY SLIM and SHAPE pitcher filters.  
Prolonged service life thanks to increased size compared to other replacement filters

### KEY FEATURES:

1. ECOMIX® filter media purifies tap water from various impurities including chlorine and chlorination by-products, hardness and salinity, lead, iron, copper, manganese
2. Prevention of bacteria thanks to silver components
3. Optimal and constant filtration rate thanks to the special construction



Model  
CRVKDEWBECO



Model  
CRVK3DEWBECO



Model  
CRVK6DEWBECO

## REPLACEMENT FILTERS FOR ECOSOFT DEWBERRY PITCHER FILTERS

Code	Product	List price, EUR	Pieces in box	Boxes on pallet	Pieces on pallet
CRVKDEWBECO	<b>Replacement filter for Dewberry pitcher filters</b>				
	Unit weight (net/gross), kg: 0.13/0.15 lb: 0.3/0.33	6.00	18	150	2 700
	Box dimensions, m: 0.21 x 0.20 x 0.30 in: 8.3 x 7.9 x 11.8				
CRVK3DEWBECO	<b>Pack of 3 replacement filters for Dewberry pitcher filters</b>				
	Unit weight (net/gross), kg: 0.38/0.43 lb: 0.8/0.9	15.00	6	175	1 050
	Box dimensions, m: 0.21 x 0.20 x 0.30 in: 8.3 x 7.9 x 11.8				
CRVK6DEWBECO	<b>Pack of 6 replacement filters for Dewberry pitcher filters</b>				
	Unit weight (net/gross), kg: 0.76/0.86 lb: 1.7/1.9	30.00	4	108	432
	Box dimensions, m: 0.21 x 0.25 x 0.30 in: 8.3 x 9.8 x 11.8				

## ECOSOFT LUNA PITCHER FILTER



### DESCRIPTION:

The most affordable and effective way to get drinking water in your kitchen

Total volume — 3.5 L

Purified water volume — 2 L

### KEY FEATURES:

1. Legendary ECOMIX® technology to purify water from common impurities
2. Flip for easy water pouring
3. Spout to protect pure water from dust
4. Non-slip base for extra immobility

## ECOSOFT MAXIMA PITCHER FILTER



### DESCRIPTION:

A simple way to get drinking water for the big family in your kitchen

Total volume — 5 L

Purified water volume — 3.5 L

### KEY FEATURES:

1. Legendary ECOMIX® technology to purify water from common impurities
2. Flip for easy water pouring
3. Spout to protect pure water from dust
4. Non-slip base for extra immobility
5. Available in three colors

### ECOSOFT LUNA AND MAXIMA PITCHER FILTERS

Code	Product	List price, EUR	Pieces in box	Boxes on pallet	Pieces on pallet
FMVLUNABEXP	<b>LUNA blue pitcher filter</b> Unit weight (net/gross), kg: 0.90/0.95 (lb: 1.98/2.10) Box dimensions, m: 0.82 x 0.22 x 0.27 (in: 32.3 x 8.7 x 10.6)	11.00	4	40	160
FMVMAXIMABEXP	<b>MAXIMA blue pitcher filter</b> Unit weight (net/gross), kg: 1.10/1.15 (lb: 2.2/2.31) Box dimensions, m: 0.86 x 0.23 x 0.30 (in: 33.9 x 9.1 x 11.8)	14.00	4	35	140
FMVMAXIMAGEXP	<b>MAXIMA green pitcher filter</b> Unit weight (net/gross), kg: 1.10/1.15 (lb: 2.2/2.31) Box dimensions, m: 0.86 x 0.23 x 0.30 (in: 33.9 x 9.1 x 11.8)	14.00	4	35	140
FMVMAXIMAREXP	<b>MAXIMA red pitcher filter</b> Unit weight (net/gross), kg: 1.10/1.15 (lb: 2.2/2.31) Box dimensions, m: 0.86 x 0.23 x 0.30 (in: 33.9 x 9.1 x 11.8)	14.00	4	35	140

# REPLACEMENT FILTER FOR ECOSOFT PITCHER FILTERS



## DESCRIPTION:

The replacement filter is filled with the ECOMIX® media that reduces a wide range of typical impurities in tap water including chlorine, hardness, iron, manganese, natural organic matter and oil products



Model  
CRVKEXP



Model  
CRVK2EXP



Model  
CRVK4EXP

## REPLACEMENT FILTERS FOR ECOSOFT PITCHER FILTERS

Code	Product	List price, EUR	Pieces in box	Boxes on pallet	Pieces on pallet
CRVKEXP	<b>Replacement filter for Ecosoft pitcher filter</b> Unit weight (net/gross), kg: 0.09/0.10 lb: 2.2/2.31 Box dimensions, m: 0.21 x 0.20 x 0.30 in: 8.3 x 7.9 x 11.8	4.30	18	150	2 700
CRVK2EXP	<b>Pack of 2 replacement filters for Ecosoft pitcher filters</b> Unit weight (net/gross), kg: 0.19/0.20 lb: 0.41/0.44 Box dimensions, m: 0.40 x 0.26 x 0.30 in: 15.7 x 10.2 x 11.8	8.00	12	80	960
CRVK4EXP	<b>Pack of 4 replacement filters for Ecosoft pitcher filters</b> Unit weight (net/gross), kg: 0.09/0.1 lb: 2.2/2.31 Box dimensions, m: 0.37x0.38x0.13 in: 22.8 x 17.7 x 15.4	12.90	6	80	480

## UNIVERSAL REPLACEMENT FILTER FOR PITCHER FILTERS



### DESCRIPTION:

Applicable for pitcher filters of the majority of Russian manufacturers.

The replacement filter is filled with the ECOMIX® media that reduces chlorine, hardness, natural organic matter and oil products

## MAX REPLACEMENT FILTER FOR PITCHER FILTERS



### DESCRIPTION:

Applicable for pitcher filters of European manufacturers.

The replacement filter is filled with the ECOMIX® media that reduces chlorine, hardness, natural organic matter and oil products

### UNIVERSAL AND MAX REPLACEMENT FILTERS FOR PITCHER FILTERS

Code	Product	List price, EUR	Pieces in box	Boxes on pallet	Pieces on pallet
CRVKABEXP	<b>Universal replacement filter for pitcher filter</b>				
	Unit weight (net/gross), kg: 0.09/0.10 lb: 2.2/2.31	4.30	18	150	2 700
	Box dimensions, m: 0.21 x 0.20 x 0.30 in: 8.3 x 7.9 x 11.8				
CMVKMAXEXP	<b>MAX replacement filter for pitcher filter</b>				
	Unit weight (net/gross), kg: 0.12/0.13 lb: 0.26/0.29	5.00	24	72	1 728
	Box dimensions, m: 0.26 x 0.26 x 0.25 in: 10.2 x 10.2 x 9.8				



## REPLACEMENT FILTERS

Replacement filters are the heart of a filter without which it cannot work.

We manufacture replacement filters of different sizes for all common water impurities.

So you can pick the filter element that would be perfect for your water.

The timely replacement of the filter is required to provide uninterrupted source of pure water 24/7/365.

## ECOSOFT SETS OF REPLACEMENT FILTERS

### ECOSOFT SET OF REPLACEMENT FILTERS FOR 3-STAGE FILTER

Model CMV3ECOEXP

#### FILTRATION TECHNOLOGY:

- 5-micron PP melt blown sediment filter — reduces content of sand, silt, scale and other insoluble compounds
- Filter with ECOMIX® D37 advanced softening material — reduces hardness, chlorine, and concentration of toxic heavy metals
- CTO coconut shell carbon filter — reduces content of chlorination by-products and sediments



### ECOSOFT SET OF REPLACEMENT FILTERS 1-2-3 FOR REVERSE OSMOSIS FILTER

Model CPV3ECOEXP

#### FILTRATION TECHNOLOGY:

- 5-micron sediment filter — reduces content of sand, silt, scale and other insoluble compounds exceeding the size of 5 microns
- Granular activated carbon (GAC) filter — reduces content of chlorine, chlorination by-products, natural organic matter and oil products
- 1-micron sediment filter — reduces content of sand, silt, scale and other insoluble compounds exceeding the size of 1 micron



### ECOSOFT SET OF IMPROVED REPLACEMENT FILTERS 1-2-3 FOR REVERSE OSMOSIS FILTER

Model CHV3ECOEXP

#### FILTRATION TECHNOLOGY:

- 5-micron sediment filter — reduces content of sand, silt, scale and other insoluble compounds exceeding the size of 5 microns
- Granular activated carbon (GAC) filter — reduces content of chlorine, chlorination by-products, natural organic matter and oil products
- CTO coconut shell carbon filter — reduces content of chlorination by-products and sediments



Unit weight (net/gross), kg: 0.95/0.97

lb: 2.09/2.14

Box dimensions, m: 0.48 x 0.32 x 0.27

in: 18.9 x 12.6 x 10.6

#### ECOSOFT SETS OF REPLACEMENT FILTERS

Code	Product	List price, EUR	Pieces in box	Boxes on pallet	Pieces on pallet
CMV3ECOEXP	Ecosoft set of replacement filters for 3-stage water filters	16.00	8	42	336
CPV3ECOEXP	Ecosoft set of replacement filters 1-2-3 for reverse osmosis filters	9.00	8	42	336
CHV3ECOEXP	Ecosoft set of improved replacement filters 1-2-3 for reverse osmosis filters	13.00	8	42	336

# CONSUMABLES FOR REVERSE OSMOSIS FILTERS

## ECOSOFT SET OF REPLACEMENT FILTERS 4-5 FOR REVERSE OSMOSIS FILTER

Model CSVRO50ECOST

### FILTRATION TECHNOLOGY:

- Reverse osmosis membrane element — purifies water from 99.8% of impurities including bacteria and viruses, unpleasant tastes or odors
- Coconut shell carbon post-filter — improves taste and odor of the purified water



## ECOSOFT CARBON POST-FILTER FOR REVERSE OSMOSIS FILTER

Model CHV2010ECO

### KEY FEATURES:

1. Tasty water thanks to coconut shell carbon
2. Simple installation with pressed-fit fittings
3. Filter housing made of pure European food grade plastic
4. Manufacturer assurance — all the filters are tested and approved for domestic application



## ECOSOFT MINERALIZATION FILTER FOR REVERSE OSMOSIS FILTER

Model PD2010ECO

### KEY FEATURES:

1. Water is enriched with the minerals essential for human health
2. Delicious taste thanks to coconut shell carbon
3. Simple installation with pressed-fit fittings
4. Filter housing made of pure European food grade plastic
5. Manufacturer assurance — all the filters are tested and approved for domestic application



## CONSUMABLES FOR REVERSE OSMOSIS FILTERS

Code	Product	List price, EUR	Pieces in box	Boxes on pallet	Pieces on pallet
CSVRO50ECOST	<b>Ecosoft set of replacement filters 4-5 for reverse osmosis filter</b> Unit weight (net/gross), kg: 0.52/0.53 (lb: 1.15/1.17) Box dimensions, m: 0.32 x 0.39 x 0.29 (in: 12.6 x 15.35 x 11.42)	32.00	18	45	810
CHV2010ECO	<b>Ecosoft carbon post-filter for reverse osmosis filter</b> Unit weight (net/gross), kg: 0.35/0.4 (lb: 0.77/0.88) Box dimensions, m: 0.39 x 0.31 x 0.29 (in: 15.4 x 12.2 x 11.42)	7.00	30	54	1 620
PD2010ECO	<b>Ecosoft mineralization filter for reverse osmosis filter</b> Unit weight (net/gross), kg: 0.23/0.24 (b: 0.51/0.53) Box dimensions, m: 0.39 x 0.31 x 0.29 (in: 15.4 x 12.2 x 11.42)	9.00	30	54	1 620

## ECOSOFT RESIDENTIAL REVERSE OSMOSIS MEMBRANE ELEMENTS

### DESCRIPTION:

Ecosoft residential reverse osmosis membrane elements are made to provide pure and tasty drinking water with stable high quality.

### KEY FEATURES:

1. Industry's leading DOW Filmtec™ membrane flat sheet from the USA
2. Up to 20% higher performance and up to 20 min faster tank filling comparing to many competitive products
3. High stabilized salt rejection 97,4 %
4. The performance is unchanged even in cold water
5. The fully-automated line provides the stable quality winding
6. Every Ecosoft membrane element is individually vacuum tested



### TECHNICAL DATA AND OPERATIONAL PARAMETERS

Code	Element Type	Average permeate flow rate, L/h (GPD)	Stabilized Salt Rejection, %	Applied pressure, bar (psi)
CSV181250ECO	50 GPD	7.9 (50)	97.4	3.4 (50)
CSV181275ECO	75 GPD	12.0 (75)	97.4	3.4 (50)
CSV1812100ECO	100 GPD	15.8 (100)	97.4	3.4 (50)

1. Permeate flow and salt rejection based on the following test conditions: 250 ppm softened tap water, 25 °C (77 °F), 15% recovery and the specified applied pressure
2. Minimum salt rejection is 95%
3. Permeate flow for individual elements for warranty evaluation may vary  $\pm 20\%$

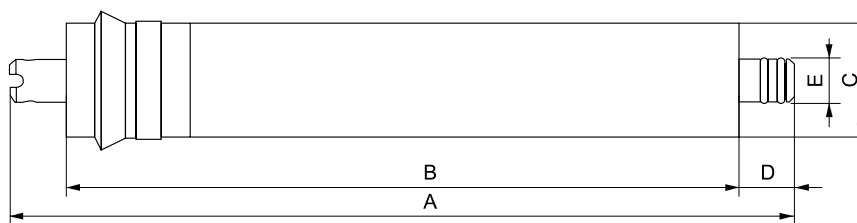

### MEMBRANE ELEMENTS DIMENSIONS

Element Type	A	B	C	D	E
50 GPD		236 $\pm$ 2 mm (9.29")			
75 GPD	297 $\pm$ 1 mm (11.73")		$\varnothing$ 45 $\pm$ 2 mm (1.775 $\pm$ 0.07")	22 $\pm$ 2 mm (0.87")	$\varnothing$ 17 $\pm$ 0,3 mm (0.67")
100 GPD		254 $\pm$ 2 (9.985")			

Unit weight (net/gross), kg: 0.18/0.18  
lb: 0.4/0.4

Box dimensions, m: 0.35 x 0.35 x 0.31  
in: 13.8 x 13.8 x 12.2

### ECOSOFT RESIDENTIAL REVERSE OSMOSIS MEMBRANE ELEMENTS

Code	Product	List price, EUR	Pieces in box	Boxes on pallet	Pieces on pallet
CSV181250ECO	<b>Ecosoft 50 GPD membrane element</b>	25.00	25	48	1 200
CSV181275ECO*	<b>Ecosoft 75 GPD membrane element</b>	28.00	25	48	1 200
CSV1812100ECO	<b>Ecosoft 100 GPD membrane element</b>	38.00	25	48	1 200

\* Available to order from 01.11.2018

# ECOSOFT GRANULAR ACTIVATED CARBON REPLACEMENT FILTERS

## DESCRIPTION:

The filters reduce content of chlorine and chlorination by-products, phenol, oil products and pesticides. Improve colour, taste, and odor of water.

The replacement filters contain 100% high-quality activated granular coconut shell carbon.

Filter housings are designed in such way that the water flow passes from the bottom up, providing continuous "fluffing" and increasing the time of water contact with the filter media.

So activated carbon sorption capacity is at its maximum

## KEY FEATURES:

1. Tasty water thanks to 100% granular coconut shell carbon
2. Contain a sediment post-filter to retain carbon particles
3. Filter housing made of pure European food grade plastic
4. Standard size replacement filters



## SPECIFICATIONS:

Code	Size	Operating water temperature °C (°F)	Recommended flow rate LPM (GPM)	Maximum capacity L (gal)	Maximum capacity month
CHV2510ECOEXP	9 7/8" x 2 1/2" (250±2 mm x 72±1 mm)	+3...+43 (37...109)	1.0 (0.3)	10 000 (2 700)	6
CHV4510ECOEXP	9 7/8" x 4 1/2" (250±2 mm x 114±1 mm)	+3...+43 (37...109)	5.0 (1.3)	30 000 (8 000)	6
CHV4520ECOEXP	20" x 4 1/2" (508±2 mm x 114±1 mm)	+3...+43 (37...109)	5.0 (1.3)	60 000 (16 000)	6

## ECOSOFT GRANULAR ACTIVATED CARBON REPLACEMENT FILTERS

Code	Product	List price, EUR	Pieces in box	Boxes on pallet	Pieces on pallet
CHV2510ECOEXP	<b>Ecosoft granular activated carbon replacement filter 2.5"×10"</b> Unit weight (net/gross), kg: 0.40/0.40 lb: 0.88/0.88 Box dimensions, m: 0.39 x 0.31 x 0.29 in: 15.4 x 12.2 x 11.4	5.00	20	54	1 080
CHV4510ECOEXP	<b>Ecosoft granular activated carbon replacement filter 4.5"×10"</b> Unit weight (net/gross), kg: 1.17/1.3 lb: 2.58/2.87 Box dimensions, m: 0.37 x 0.25 x 0.54 in: 14.6 x 9.8 x 21.3	19.00	12	42	504
CHV4520ECOEXP	<b>Ecosoft granular activated carbon replacement filter 4.5"×20"</b> Unit weight (net/gross), kg: 2.16/2.2 lb: 4.76/4.85 Box dimensions, m: 0.37 x 0.25 x 0.54 in: 14.6 x 9.8 x 21.3	33.00	6	42	252

## ECOSOFT CARBON BLOCK REPLACEMENT FILTERS

### DESCRIPTION:

The filters reduce content of chlorine and chlorination by-products, phenol, oil products and pesticides. Improve colour, taste, and odor of water.

The filtration media is presented by activated coconut shell carbon block.

Replacement filters are made with application of the special technology that provides uniformity of structure, i.e. filtration with all the surface of the filter. So activated carbon sorption capacity is at its maximum

### KEY FEATURES:

1. Tasty water thanks to coconut shell carbon block
2. The filters also reduce sediments larger than 10 micron thanks to block structure
3. Uniformity of structure, i.e. filtration with all the surface of the filter
4. Standard size replacement filters



### SPECIFICATIONS:

Code	Size	Operating water temperature °C (°F)	Recommended flow rate LPM (GPM)	Maximum capacity L (gal)	Maximum capacity month
CHVCB2510ECOEXP	9 7/8" x 2 1/2" (250±2 mm x 67±0.5 mm)	+3...+43 (37...109)	1.0 (0.3)	15 000 (4 000)	6
CHVCB4510ECOEXP	9 7/8" x 4 1/2" (250±2 mm x 114±1 mm)	+3...+43 (37...109)	5.0 (1.3)	25 000 (6 600)	6
CHVCB4520ECOEXP	20" x 4 1/2" (508±2 mm x 114±1 mm)	+3...+43 (37...109)	5.0 (1.3)	50 000 (13 200)	6

### ECOSOFT CARBON BLOCK REPLACEMENT FILTERS

Code	Product	List price, EUR	Pieces in box	Boxes on pallet	Pieces on pallet
CHVCB2510ECOEXP	<b>Ecosoft CTO coconut shell carbon block filter 2.5"×10"</b> Unit weight (net/gross), kg: 0.35/0.35 lb: 0.77/0.77 Box dimensions, m: 0.39 x 0.31 x 0.29 in: 15.4 x 12.2 x 11.4	6.00	20	54	1 080
CHVCB4510ECOEXP	<b>Ecosoft CTO coconut shell carbon block filter 4.5"×10"</b> Unit weight (net/gross), kg: 1.10/1.23 lb: 2.43/2.71 Box dimensions, m: 0.37 x 0.25 x 0.54 in: 14.6 x 9.8 x 21.30	21.00	12	42	504
CHVCB4520ECOEXP	<b>Ecosoft CTO coconut shell carbon block filter 4.5"×20"</b> Unit weight (net/gross), kg: 2.3/2.43 lb: 5.07/5.36 Box dimensions, m: 0.37 x 0.25 x 0.54 in: 14.6 x 9.8 x 21.30	35.00	6	42	252



## ECOSOFT REPLACEMENT FILTER FOR HARDNESS REDUCTION

**DESCRIPTION:** The filter reduces hardness which leads to formation of deposits on sanitary ware and scale on the surface of heating elements. The filtration media is a food grade Na<sup>+</sup> ion-exchange resin. Filter housings are designed in such way that the water flow passes from the bottom up, providing continuous "fluffing" and increasing the time of water contact with the filter media. So the ion-exchange resin capacity is at its maximum

### KEY FEATURES:

1. No scale while boiling water
2. Contains a sediment post-filter to retain filter media particles
3. Filter housing made of pure European food grade plastic
4. Standard size replacement filter

### SPECIFICATIONS:

Code	Size	Operating water temperature °C (°F)	Recommended flow rate LPM (GPM)	Maximum capacity L (gal)	Maximum capacity month
CMV2510ECOEXP	9 7/8" x 2 1/2" (250±2 mm x 72±1 mm)	+3...+43 (37...109)	1.0 (0.3)	500 (130)	6

### ECOSOFT REPLACEMENT FILTER FOR HARDNESS REDUCTION

Code	Product	List price, EUR	Pieces in box	Boxes on pallet	Pieces on pallet
CMV2510ECOEXP	<b>Ecosoft replacement filter for hardness reduction 2.5"×10"</b> Unit weight (net/gross), kg: 0.40/0.40 (lb: 0.88/0.88) Box dimensions, m: 0.39 x 0.31 x 0.29 (in: 15.4 x 12.2 x 11.4)	6.00	20	54	1 080



## ECOSOFT REPLACEMENT FILTER WITH ECOMIX® MEDIA

**DESCRIPTION:** The filter reduces hardness, chlorine and chlorination by-products, concentration of toxic heavy metals, phenol, oil products, natural organic matter, iron, and manganese. Improves colour, taste, and odor of water. The replacement filter contains the legendary ECOMIX® media specifically created to purify tap water from common contaminants. Filter housing is designed in such way that the water flow passes from the bottom up, providing continuous "fluffing" and increasing the time of water contact with the filter media. So the filter media capacity is at its maximum

### KEY FEATURES:

1. High-quality purification of hard tap water containing excessive amounts of iron and natural organic matter
2. Contains a sediment post-filter to retain filter media particles
3. Filter housing made of pure European food grade plastic
4. Standard size replacement filter

### SPECIFICATIONS:

Code	Size	Operating water temperature °C (°F)	Recommended flow rate LPM (GPM)	Maximum capacity L (gal)	Maximum capacity month
CRV2510ECOEXP	9 7/8" x 2 1/2" (250±2 mm x 72±1 mm)	+3...+43 (37...109)	1.0 (0.3)	1 500 (200)	6

### ECOSOFT REPLACEMENT FILTER WITH ECOMIX® MEDIA

Code	Product	List price, EUR	Pieces in box	Boxes on pallet	Pieces on pallet
CRV2510ECOEXP	<b>Ecosoft replacement filter with ECOMIX® media 2.5"×10"</b> Unit weight (net/gross), kg: 0.40/0.40 (lb: 0.88/0.88) Box dimensions, m: 0.39 x 0.31 x 0.29 (in: 15.4 x 12.2 x 11.4)	12.00	20	54	1 080



## ECOSOFT REPLACEMENT FILTERS FOR IRON REDUCTION

### DESCRIPTION:

The filters reduce content of iron and its by-products in well water, as well as decrease concentration of oil products and pesticides. Improve colour, taste, and odor of water.

The replacement filters contain the blend of catalytic sorption material, high-quality activated carbon, and pH corrector.

Filter housings are designed in such way that the water flow passes from the bottom up, providing continuous "fluffing" and increasing the time of water contact with the filter media. So the filter media capacity is at its maximum

### KEY FEATURES:

1. Reduction of iron up to 80%
2. Contain a sediment post-filter to retain filter media particles
3. Filter housings made of pure European food grade plastic
4. Standard size replacement filter



### SPECIFICATIONS:

Code	Size	Operating water temperature °C (°F)	Recommended flow rate LPM (GPM)	Maximum capacity L (gal)	Maximum capacity month
CRVF2510ECOEXP	9 7/8" x 2 1/2" (250±2 mm x 72±1 mm)	+3...+43 (37...109)	1.0 (0.3)	2 500 (660)	6
CRVF4520ECOEXP	20" x 4 1/2" (508±2 mm x 114±1 mm)	+3...+43 (37...109)	5.0 (1.3)	10 000 (2 700)	6

### ECOSOFT REPLACEMENT FILTERS FOR IRON REDUCTION

Code	Product	List price, EUR	Pieces in box	Boxes on pallet	Pieces on pallet
CRVF2510ECOEXP	<b>Ecosoft replacement filter for iron reduction 2.5"×10"</b> Unit weight (net/gross), kg: 0.40/0.40 lb: 0.88/0.88 Box dimensions, m: 0.39 x 0.31 x 0.29 in: 15.4 x 12.2 x 11.4	6.00	20	54	1 080
CRVF4520ECOEXP	<b>Ecosoft replacement filter for iron reduction 4.5"×20"</b> Unit weight (net/gross), kg: 2.16/2.2 lb: 4.76/4.85 Box dimensions, m: 0.37 x 0.25 x 0.54 in: 14.6 x 9.8 x 21.3	33.00	6	42	252

# ECOSOFT REPLACEMENT FILTERS FOR HYDROGEN SULFIDE REDUCTION

## DESCRIPTION:

The filters reduce content of hydrogen sulfide in well water, as well as the organic matter including oil products and pesticides. Improve colour, taste, and odor of water.

The replacement filters contain the Centaur catalytic activated carbon.

Filter housings are designed in such way that the water flow passes from the bottom up, providing continuous "fluffing" and increasing the time of water contact with the filter media. So activated carbon sorption capacity is at its maximum

## KEY FEATURES:

1. Access to pure water without odors or flavors
2. Contain a sediment post-filter to retain carbon particles
3. Filter housings made of pure European food grade plastic
4. Standard size replacement filters



## SPECIFICATIONS:

Code	Size	Operating water temperature °C (°F)	Recommended flow rate LPM (GPM)	Maximum capacity L (gal)	Maximum capacity month
CRVS4510ECOEXP	9 7/8" x 4 1/2" (250±2 mm x 114±1 mm)	+3...+43 (37...109)	5.0 (1.3)	15 000 (4 000)	6
CRVS4520ECOEXP	20" x 4 1/2" (508±2 mm x 114±1 mm)	+3...+43 (37...109)	5.0 (1.3)	30 000 (8 000)	6

## ECOSOFT REPLACEMENT FILTERS FOR HYDROGEN SULFIDE REDUCTION

Code	Product	List price, EUR	Pieces in box	Boxes on pallet	Pieces on pallet
CRVS4510ECOEXP	<b>Ecosoft replacement filter for hydrogen sulfide reduction 4.5"×10"</b> Unit weight (net/gross), kg: 1.17/1.3 lb: 2.58/2.87 Box dimensions, m: 0.37 x 0.25 x 0.54 in: 14.6 x 9.8 x 21.3	30.00	12	42	504
CRVS4520ECOEXP	<b>Ecosoft replacement filter for hydrogen sulfide reduction 4.5"×20"</b> Unit weight (net/gross), kg: 2.16/2.2 lb: 4.76/4.85 Box dimensions, m: 0.37 x 0.25 x 0.54 in: 14.6 x 9.8 x 21.3	53.00	6	42	252

## ECOSOFT PP SEDIMENT REPLACEMENT FILTERS

### DESCRIPTION:

The filters are intended to purify water from sediment particles such as rust, sand, scale, silt etc.

The replacement filter is produced from a durable polypropylene cord that is wound around a rigid polypropylene core.

The filtration rating is provided by string pattern and thread tension. So the more dense is the pattern, the smaller size of the particles it is able to retain

### KEY FEATURES:

1. Protection of plumbing and fixtures
2. Stable winding density characteristics
3. Quality string from the Ukrainian manufacturer
4. Standard size replacement filters



### SPECIFICATIONS:

Code	Size	Operating water temperature °C (°F)	Recommended flow rate LPM (GPM)	Maximum capacity L (gal)	Maximum capacity month
CPN25101ECOEXP	9 7/8" x 2 1/2" (250±2 mm x 60±2 mm)	+3...+60 (37...140)	8.0 (2.0)	10 000 (2 700)	6
CPN25105ECOEXP	9 7/8" x 2 1/2" (250±2 mm x 60±2 mm)	+3...+60 (37...140)	8.0 (2.0)	10 000 (2 700)	6
CPN251010ECOEXP	9 7/8" x 2 1/2" (250±2 mm x 60±2 mm)	+3...+60 (37...140)	8.0 (2.0)	10 000 (2 700)	6
CPN251020ECOEXP	9 7/8" x 2 1/2" (250±2 mm x 60±2 mm)	+3...+60 (37...140)	8.0 (2.0)	10 000 (2 700)	6
CPN45105ECOEXP	10" x 4 1/2" (254±2 mm x 112±2 mm)	+3...+60 (37...140)	15.0 (4.0)	40 000 (10 500)	6
CPN452020ECOEXP	20" x 4 1/2" (514±2 mm x 112±2 mm)	+3...+60 (37...140)	30.0 (5.0)	80 000 (21 000)	6

### ECOSOFT PP STRING WOUND SEDIMENT REPLACEMENT FILTERS

Code	Product	List price, EUR	Pieces in box	Boxes on pallet	Pieces on pallet
CPN25101ECOEXP	<b>PP string wound sediment filter 2.5"×10" 1-micron</b> Unit weight (net/gross), kg: 0.2/0.2 (lb: 0.44/0.44) Box dimensions, m: 0.37 x 0.26 x 0.51 (in: 14.6 x 10.2 x 20.1)	2.16	48	48	2 304
CPN25105ECOEXP	<b>PP string wound sediment filter 2.5"×10" 5-micron</b> Unit weight (net/gross), kg: 0.2/0.2 (lb: 0.44/0.44) Box dimensions, m: 0.37 x 0.26 x 0.51 (in: 14.6 x 10.2 x 20.1)	2.16	48	48	2 304
CPN251010ECOEXP	<b>PP string wound sediment filter 2.5"×10" 10-micron</b> Unit weight (net/gross), kg: 0.2/0.2 (lb: 0.44/0.44) Box dimensions, m: 0.37 x 0.26 x 0.51 (in: 14.6 x 10.2 x 20.1)	2.16	48	48	2 304
CPN251020ECOEXP	<b>PP string wound sediment filter 2.5"×10" 20-micron</b> Unit weight (net/gross), kg: 0.2/0.2 (lb: 0.44/0.44) Box dimensions, m: 0.37 x 0.26 x 0.51 (in: 14.6 x 10.2 x 20.1)	2.16	48	48	2 304
CPN45105ECOEXP	<b>PP string wound sediment filter 4.5"×10" 5-micron</b> Unit weight (net/gross), kg: 0.7/0.71 (lb: 1.53/1.57) Box dimensions, m: 0.24 x 0.36 x 0.52 (in: 9.5 x 14.2 x 20.5)	8.90	12	42	504
CPN452020ECOEXP	<b>PP string wound sediment filter 4.5"×20" 20-micron</b> Unit weight (net/gross), kg: 1.39/1.42 (lb: 3.06/3.13) Box dimensions, m: 0.24 x 0.36 x 0.52 (in: 9.5 x 14.2 x 20.5)	19.90	6	42	252

# ECOSOFT DUAL GRADIENT PP SEDIMENT REPLACEMENT FILTER

## DESCRIPTION:

The filter is intended to purify water from sediment particles such as rust, sand, scale, silt etc. Dual gradient design allows creating two distinct filter zones. Larger particles are trapped and filtered out in the first zone and the smaller particles are trapped in the second zone. It allows the cartridge to operate at higher velocities and lower pressure drop

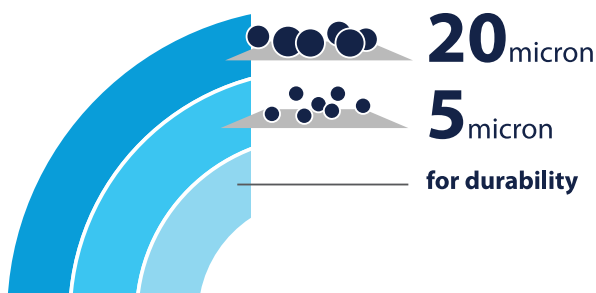

## KEY FEATURES:

1. 3 times higher capacity comparing to standard PP replacement filters
2. 3 times higher rejection rates
3. Low losses of pressure
4. Stable operation even in case of water turbidity changes
5. Superior quality, saving costs and space

## SPECIFICATIONS:

Code	Size	Operating water temperature °C (°F)	Recommended flow rate LPM (GPM)	Maximum capacity L (gal)	Maximum capacity month
CPV2510205ECO	9 7/8" x 2 1/2" (250±2 mm x 60±2 mm)	+3...+43	8.0	30 000	6

## ECOSOFT DUAL GRADIENT PP SEDIMENT REPLACEMENT FILTER

Code	Product	List price, EUR	Pieces in box	Boxes on pallet	Pieces on pallet
CPV2510205ECO	<b>Ecosoft dual gradient PP sediment filter 2.5"×10" 20-5 micron</b> Unit weight (net/gross), kg: 0.1/0.1 lb: 0.22/0.22 Box dimensions, m: 0.37 x 0.26 x 0.51 in: 14.6 x 10.2 x 20.1	2.30	48	48	2 304

## ECOSOFT PP MELT BLOWN SEDIMENT REPLACEMENT FILTERS

### DESCRIPTION:

The filters are intended to purify water from sediment particles such as rust, sand, scale, silt etc.

The replacement filter represents a polypropylene porous cylinder produced using the melt-blown technique.

Necessary degree of rigidity is achieved without application of core by melting fibers into the rigid structure



### KEY FEATURES:

1. Protection of plumbing and sanitary ware
2. Stable characteristics for retention of the particles
3. European high melt flow PP
4. Standard size replacement filters

### SPECIFICATIONS:

Code	Size	Operating water temperature °C (°F)	Recommended flow rate LPM (GPM)	Maximum capacity L (gal)	Maximum capacity month
CPV25101ECOEXP	9 7/8" x 2 1/2" (250±1 mm x 60±1 mm)	+3...+43 (37...109)	8.0 (2.0)	10 000 (2 700)	6
CPV25105ECOEXP	9 7/8" x 2 1/2" (250±1 mm x 60±1 mm)	+3...+43 (37...109)	8.0 (2.0)	10 000 (2 700)	6
CPV251010ECOEXP	9 7/8" x 2 1/2" (250±1 mm x 60±1 mm)	+3...+43 (37...109)	8.0 (2.0)	10 000 (2 700)	6
CPV251020ECOEXP	9 7/8" x 2 1/2" (250±1 mm x 60±1 mm)	+3...+43 (37...109)	8.0 (2.0)	10 000 (2 700)	6
CPV2510HWECOEXP	9 7/8" x 2 1/2" (250±1 mm x 60±1 mm)	+3...+75 (37...167)	8.0 (2.0)	10 000 (2 700)	6
CPV25205ECOEXP	20" x 2 1/2" (510±2 mm x 60±1 mm)	+3...+43 (37...109)	15.0 (4.0)	20 000 (5 400)	6
CPV25305ECOEXP	30" x 2 1/2" (760±2 mm x 60±1 mm)	+3...+43 (37...109)	20.0 (5.0)	30 000 (8 100)	6
CPV25405ECOEXP	40" x 2 1/2" (1019±2 mm x 60±1 mm)	+3...+43 (37...109)	25.0 (6.0)	40 000 (10 500)	6
CPV45105ECOEXP	10" x 4 1/2" (254±1 mm x 114±1 mm)	+3...+43 (37...109)	15.0 (4.0)	40 000 (10 500)	6
CPV45205ECOEXP	20" x 4 1/2" (510±2 mm x 114±1 mm)	+3...+43 (37...109)	30.0 (8.0)	80 000 (21 000)	6
CPV452020ECOEXP	20" x 4 1/2" (510±2 mm x 114±1 mm)	+3...+43 (37...109)	30.0 (8.0)	80 000 (21 000)	6



## ECOSOFT PP MELT BLOWN SEDIMENT REPLACEMENT FILTERS

Code	Product	List price, EUR	Pieces in box	Boxes on pallet	Pieces on pallet
CPV25101ECOEXP	<b>PP melt blown sediment filter 2.5"×10" 1-micron</b> Unit weight (net/gross), kg: 0.1/0.1 lb: 0.22/0.22 Box dimensions, m: 0.37 x 0.26 x 0.51 in: 14.6 x 10.2 x 20.1	1.35	48	48	2 304
CPV25105ECOEXP	<b>PP melt blown sediment filter 2.5"×10" 5-micron</b> Unit weight (net/gross), kg: 0.1/0.1 lb: 0.22/0.22 Box dimensions, m: 0.37 x 0.26 x 0.51 in: 14.6 x 10.2 x 20.1	1.35	48	48	2 304
CPV251010ECOEXP	<b>PP melt blown sediment filter 2.5"×10" 10-micron</b> Unit weight (net/gross), kg: 0.1/0.1 lb: 0.22/0.22 Box dimensions, m: 0.37 x 0.26 x 0.51 in: 14.6 x 10.2 x 20.1	1.35	48	48	2 304
CPV251020ECOEXP	<b>PP melt blown sediment filter 2.5"×10" 20-micron</b> Unit weight (net/gross), kg: 0.1/0.1 lb: 0.22/0.22 Box dimensions, m: 0.37 x 0.26 x 0.51 in: 14.6 x 10.2 x 20.1	1.35	48	48	2 304
CPV2510HWECOEXP	<b>PP melt blown sediment filter for hot water 2.5"×10" 5-micron</b> Unit weight (net/gross), kg: 0.1/0.1 lb: 0.22/0.22 Box dimensions, m: 0.37 x 0.26 x 0.51 in: 14.6 x 10.2 x 20.1	1.60	48	48	2 304
CPV25205ECOEXP	<b>PP melt blown sediment filter 2.5"×20" 5-micron</b> Unit weight (net/gross), kg: 0.21/0.22 lb: 0.46/0.48 Box dimensions, m: 0.32 x 0.33 x 0.52 in: 12.6 x 13.0 x 20.5	2.70	25	27	675
CPV25305ECOEXP	<b>PP melt blown sediment filter 2.5"×30" 5-micron</b> Unit weight (net/gross), kg: 0.32/0.34 lb: 0.71/0.75 Box dimensions, m: 0.32 x 0.33 x 0.79 in: 12.6 x 13.0 x 31.1	4.10	25	18	450
CPV25405ECOEXP	<b>PP melt blown sediment filter 2.5"×40" 5-micron</b> Unit weight (net/gross), kg: 0.43/0.45 lb: 0.95/0.99 Box dimensions, m: 0.32 x 0.33 x 1.03 in: 12.6 x 13.0 x 40.55	5.40	25	18	450
CPV45105ECOEXP	<b>PP melt blown sediment filter BB10 4.5"×10" 5-micron</b> Unit weight (net/gross), kg: 0.45/0.46 lb: 0.99/1.01 Box dimensions, m: 0.24 x 0.36 x 0.52 in: 9.5 x 14.2 x 20.5	8.64	12	42	504
CPV45205ECOEXP	<b>PP melt blown sediment filter BB20 4.5"×20" 5-micron</b> Unit weight (net/gross), kg: 0.90/0.92 lb: 1.98/2.03 Box dimensions, m: 0.24 x 0.36 x 0.52 in: 9.5 x 14.2 x 20.5	16.50	6	42	252
CPV452020ECOEXP	<b>PP melt blown sediment filter BB20 4.5"×20" 20-micron</b> Unit weight (net/gross), kg: 0.90/0.92 lb: 1.98/2.03 Box dimensions, m: 0.24 x 0.36 x 0.52 in: 9.5 x 14.2 x 20.5	16.50	6	42	252



# FILTRATION SYSTEMS

We produce a wide range of filtration systems to treat the most widespread water problems, including high content of sediment impurities (silt, sand, rust, scale), iron, manganese, hardness, ammonium, organic matter, hydrogen sulfide, chlorine and its toxic compounds.

Within our filtration systems we employ filter medias from the world leading producers, such as DOW Chemical (USA), Calgon Carbon Corporation (USA), Clack Corporation (USA).

State-of-the-art control valve (developed by Ecosoft and produced by Clack Corporation) provides filter's independent service, keeps constant reserve of purified water and doesn't require any special attention.



# ADVANCED SOFTENING MATERIAL

**for problem water**

SIMPLE SOLUTION FOR 5 PROBLEMS

- hardness
- iron
- manganese
- natural organic matter
- ammonium



## FILTER MEDIA

ECOMIX® is certified in compliance with NSF/ANSI 44/61/372 standards

ECOMIX® is certified in European Union by TÜV SÜD



### SPECIFICATIONS:

	ECOMIX	HCRSS	CENT1240	FILTR300	FLAG	FLAGPL
Service flow rate, m/h (gpm/ft <sup>2</sup> )	20–25 (8–10)	20–40 (8–16)	12 (5)	12 (5)	12 (5)	12–20 (5–8)
Backwash flow rate, m/h (gpm/ft <sup>2</sup> )	12–15 (5–6)	10–15 (4–6)	20–24 (8–10)	20–24 (8–10)	20–24 (8–10)	30–35 (12–14)
Brine (slow rinse) flow rate, m/h (gpm/ft <sup>2</sup> )	3–5 (1–2)	3–5 (1–2)	—	—	—	—
Recommended bed depth, mm (in)	800 (32)	800 (32)	700–800 (28–32)	700–1000 (28–40)	600–900 (24–36)	700–900 (28–36)
Freeboard, %	40	40	50	50	50	50
Salt consumption, g/L (lbs/ft <sup>3</sup> )	100 (6.3)	100 (6.3)	—	—	—	—

### FILTER MEDIA

Code	Product	Packing	List Price, EUR*
ECOMIXA	ECOMIX® A media for well and tap water treatment	12; 25 L (0.42; 0.88 ft <sup>3</sup> )	9.00
ECOMIXC	ECOMIX® C media for treatment of well water with high organic matter content	12; 25 L (0.42; 0.88 ft <sup>3</sup> )	10.00
ECOMIXP	ECOMIX® P media for well and tap water treatment	12; 25 L (0.42; 0.88 ft <sup>3</sup> )	6.15
HCRSS	DOWEX® HCRS/S strong acid cation-exchange resin	25 L (0.88 ft <sup>3</sup> )	5.30
List Price, EUR*			
CENT1240	Centaur® 12 x 40 for hydrogen sulfide content reduction	15 kg (33 lb)	22.70
FILTR300	Filtrisorb® 300 granular activated carbon	25 kg (55 lb)	14.60
FLAG	Filter Ag® filter media	28.3 L (1 ft <sup>3</sup> )	1.50
FLAGPL	Filter Ag® Plus filter media	28.3 L (1 ft <sup>3</sup> )	2.70
KECOSILEXP	Salt pellets for water softeners	25 kg (55 lb)	0.65

\* The price is indicated for 1 L (1 kg)

Minimum order is 1 pallet of each item

## ECOSOFT PREMIUM WATER SOFTENERS

### APPLICATION:

Residential water treatment

### FILTER MEDIA:

DOWEX® HCRS/S or ECOMIX® A

### REDUCTION:

of hardness by softener

of hardness, iron, manganese, ammonium, organic matter by advanced softener

### CONTROL VALVE:

Ecosoft Clack WS1" CE (volume controlled)

### KEY FEATURES:

1. Consistently high-quality water during 5 years
2. Low salt and water consumption per regeneration
3. Automatic operation and intelligent regeneration of the filter at time convenient for customer
4. Attractive and compact design
5. Multilingual menu display with blue backlight
6. Quick and easy programming
7. Reliable and long-term operation thanks to high-quality Clack Corporation components
8. Quality and safety guaranteed by the international CE certificate
9. 36-month warranty

### COMPONENTS:

Fully assembled cabinet type filter, including:

- premium color carton box packing
- control valve with injector, DLFC, top distributor, AC transformer, user manual
- cabinet enclosure with pressure tank, riser pipe and bottom distributor
- filter media



Code	Description	Q, m³/h (nominal) (GPM)	Volume of media, L (ft³)	Dimensions, H x W x D, mm (in)	List price, EUR
<b>WATER SOFTENERS (DOWEX® HCRS/S)</b>					
FU1018CABCE	Ecosoft water softener 108 Premium	0.8 (3.5)	12 (0.48)	700 x 350 x 520 (27.5 x 13.8 x 20.5)	1 170.00
FU0835CABCE	Ecosoft water softener 113 Premium	1.3 (5.7)	18 (0.6)		1 280.00
FU1035CABCE	Ecosoft water softener 120 Premium	2 (8.8)	25 (0.88)	1130 x 350 x 520 (44.5 x 13.8 x 20.5)	1 350.00
FU1235CABCE	Ecosoft water softener 125 Premium	2.5 (11)	37 (1.3)		1 450.00
<b>ADVANCED WATER SOFTENERS (ECOMIX® A)</b>					
FK0835CABCE	Ecosoft advanced water softener 508 Premium	0.8 (3.5)	18 (0.6)		1 460.00
FK1035CABCE	Ecosoft advanced water softener 513 Premium	1.3 (5.7)	25 (0.88)	1130 x 350 x 520 (44.5 x 13.8 x 20.5)	1 610.00
FK1235CABCE	Ecosoft advanced water softener 518 Premium	1.8 (7.9)	37 (1.3)		1 760.00



# ECOSOFT STANDARD WATER SOFTENERS

## APPLICATION:

Residential water treatment

## FILTER MEDIA:

Cation exchange resin

## REDUCES:

Hardness

## CONTROL VALVE:

Clack DV (volume controlled) or BNT 165-SE (time controlled)

## KEY FEATURES:

1. High quality of water treatment
2. Super-compact water softener
3. Automatic operation and regeneration filter
4. Quality and safety guaranteed by the international CE certificate
5. 12-month warranty

## COMPONENTS:

Fully assembled cabinet type filter, including:

- carton box packing
- control valve with injector, DLFC, top distributor, AC transformer, user manual
- cabinet enclosure with pressure tank, riser pipe and bottom distributor
- filter media



## WATER SOFTENERS

Code	Description	Q, m³/h (nominal) (GPM)	Volume of media, L (ft³)	Dimensions, H x W x D, mm (in)	List price, EUR
FU0817CABDV	Ecosoft water softener 108-V Standard (volume controlled)	0.8 (3.5)	8 (0.3)	640 x 225 x 440 (25.2 x 8.8 x 17.3)	840.00
FU0817CABBNT	Ecosoft water softener 108-T Standard (time controlled)				450.00
FU0835CABDV	Ecosoft water softener 113-V Standard (volume controlled)	1.3 (5.7)	18 (0.6)	1110 x 225 x 440 (43.7 x 8.8 x 17.3)	950.00
FU0835CABBNT	Ecosoft water softener 113-T Standard (time controlled)				600.00

## ADVANCED WATER SOFTENERS (ECOMIX® A)

FK0835CABDV	Ecosoft advanced water softener 508 Standard	0.8 (3.5)	18 (0.6)	1110 x 330 x 470 (43.7 x 13.0 x 18.5)	1 140.00
FK1035CABDV	Ecosoft advanced water softener 513 Standard	1.3 (5.7)	25 (0.88)		1 260.00

# WATER SOFTENING FILTERS

## ECOSOFT FU (DOWEX® HCRS/S)

### APPLICATION:

Water softening for houses, hotels, cafes, restaurants, boilers, industrial processes

### FILTER MEDIA:

DOWEX® HCRS-S

### REDUCES:

Hardness

### CONTROL VALVE:

Volume controlled Ecosoft WS 1.0" / 1.25" / 1.5" / 2.0" CE (Clack Corporation, USA)

### KEY FEATURES:

1. Ready to use — fully equipped filter
2. Easy-to-use — advanced multifunctional control valve Ecosoft CE with multilingual menu, quick and easy programming procedure
3. Cost-saving — low consumption of salt and water during regeneration
4. Reliable and long-term operation thanks to high-quality Clack Corporation components
5. CE-marked and confirmed to be safe in accordance with EC New Approach Directives

### COMPONENTS:

- Fully assembled Ecosoft CE control valve (control valve, injector, DLFC, top distributor, AC transformer, funnel, user manual)
- Filter tank (with riser pipe and bottom distributor)
- Brine tank
- Filter media



*Anti-condensation tank cover is not included*

### WATER SOFTENING FILTERS ECOSOFT FU (DOWEX® HCRS/S)

Code	Q, m³/h (GPH) (nominal)	Volume of media, L (ft³)	Inlet/outlet size	List price, EUR
FU1054CE	2.0 (530)	37 (1.3)	1" NPT	1 275.00
FU1252CE	2.9 (765)	62 (2.2)		1 455.00
FU1354CE	3.5 (925)	75 (2.6)		1 595.00
FU1465CE	4.0 (1 055)	100 (3.5)		1 885.00
FU1665CE	5.2 (1 375)	125 (4.4)		2 130.00
FU2162CE125	6.8 (1 795)	200 (7.1)	1.25" NPT	3 300.00
FU2472CE150	11.7 (3 090)	300 (10.6)	1.5" BSPT	5 950.00
FU3072CE15	14.0 (3 700)	500 (17.7)		8 780.00
FU3672CE2	16.0 (4 225)	700 (24.7)		11 400.00
FU4272CE2	20.0 (5 285)	900 (31.8)	2" BSPT	14 000.00
FU4872CE2	24.0 (6 340)	1175 (41.5)		19 350.00

# IRON AND HARDNESS REDUCTION FILTERS ECOSOFT FK (ECOMIX® A)

## APPLICATION:

Water treatment for houses, hotels, cafes, restaurants, boilers, industrial processes

## FILTER MEDIA:

ECOMIX® A

## REDUCES:

Hardness, iron, manganese, ammonium, organic matter

## CONTROL VALVE:

Volume controlled Ecosoft WS 1.0" / 1.25" / 1.5" / 2.0" CE (Clack Corporation, USA)

## KEY FEATURES:

1. Ready to use — fully equipped filter
2. High-quality water — effective treatment of five major contaminants regardless of pH, chlorine and hydrogen sulfide content in feed water
3. Easy-to-use — advanced multifunctional control valve Ecosoft CE with multilingual menu, quick and easy programming procedure
4. Cost-saving — low purchase and operating costs due to application of one filter with combined action instead of 3–4 single action filters
5. Reliable and long-term operation thanks to high-quality Clack Corporation components
6. CE-marked and confirmed to be safe in accordance with EC New Approach Directives

## COMPONENTS:

- Fully assembled Ecosoft CE control valve (control valve, injector, DLFC, top distributor, AC transformer, funnel, user manual)
- Filter tank (with riser pipe and bottom distributor)
- Brine tank
- Filter media



*Anti-condensation tank cover  
is not included*

## IRON AND HARDNESS REDUCTION FILTERS ECOSOFT FK (ECOMIX® A)

Code	Q, m³/h (GPH) (nominal)	Volume of media, L (ft³)	Inlet/outlet size	List price, EUR
FK1054CE	1.3 (345)	37 (1.3)	1" NPT	1 510.00
FK1252CE	1.8 (475)	50 (1.8)		1 690.00
FK1354CE	2.2 (580)	62 (2.2)		1 890.00
FK1465CE	2.5 (660)	75 (2.6)		2 145.00
FK1665CE	3.3 (870)	100 (3.5)		2 425.00
FK2162CE125	5.6 (1 480)	150 (5.3)	1.25" NPT	3 605.00
FK2471CE15	7.3 (1 930)	300 (10.6)	1.5" BSPT	8 000.00
FK3072CE15	11.5 (3 040)	450 (15.9)		11 650.00
FK3672CE2	16.4 (4 330)	650 (23.0)		15 750.00
FK4272CE2	20.0 (5 285)	850 (30.0)	2" BSPT	19 900.00
FK4872CE2	24.0 (6 340)	1100 (38.8)		26 800.00

# WATER SOFTENING FILTERS OF CONTINUOUS FLOW ECOSOFT FU TWIN

## APPLICATION:

Hotels, boilers, industrial processes

## FILTER MEDIA:

DOWEX® HCRS-S

## REDUCES:

Hardness

## CONTROL VALVE:

Volume controlled Ecosoft WS 1.0" CE TWIN (Clack Corporation, USA)

## KEY FEATURES:

1. Ready to use — fully equipped filter
2. Uninterrupted pure water supply 24/7
3. Easy-to-use — advanced multifunctional control valve Ecosoft CE with multilingual menu, quick and easy programming procedure
4. Cost-saving — low consumption of salt and water during regeneration
5. Reliable and long-term operation thanks to high-quality Clack Corporation components
6. CE marked and confirmed to be safe in accordance with EC New Approach Directives

## COMPONENTS:

- Fully assembled Ecosoft CE TWIN control valve (control valve, injector, DLFC, top distributor, AC transformer, funnel, user manual)
- Filter tanks (with riser pipe and bottom distributor)
- Brine tank
- Filter media



*Anti-condensation tank cover  
is not included*

## WATER SOFTENING FILTERS ECOSOFT FU TWIN (DOWEX® HCRS/S)

Code	Q, m <sup>3</sup> /h (GPH) (nominal)	Volume of media, L (ft <sup>3</sup> )	Inlet/outlet size	List price, EUR
FU1054TWIN	2.0 (530)	75 (2.6)	1" NPT	2 180.00
FU1252TWIN	2.9 (765)	125 (4.4)		2 660.00
FU1354TWIN	3.5 (925)	150 (5.3)		2 835.00
FU1465TWIN	4.0 (1 055)	200 (7.1)		3 300.00
FU1665TWIN	5.2 (1 375)	250 (8.8)		3 660.00
FU2162TWIN	6.3 (1 665)	400 (14.1)	1.25" NPT	6 100.00

# IRON AND HARDNESS REDUCTION FILTERS OF CONTINUOUS FLOW ECOSOFT FK TWIN

## APPLICATION:

Private houses, boilers, industrial processes

## FILTER MEDIA:

ECOMIX® A

## REDUCES:

Hardness, iron, manganese, ammonium, organic matter

## CONTROL VALVE:

Volume controlled Ecosoft WS 1.0" CE TWIN (Clack Corporation, USA)

## KEY FEATURES:

1. Ready to use — fully equipped filter
2. Uninterrupted pure water supply 24/7
3. High-quality water — effective treatment of five major contaminants regardless of pH, chlorine and hydrogen sulfide content in feed water
4. Easy-to-use — advanced multifunctional control valve Ecosoft CE with multilingual menu, quick and easy programming procedure
5. Cost-saving — low purchase and operating costs due to application of one filter with combined action instead of 3–4 single action filters
6. Reliable and long-term operation thanks to high-quality Clack Corporation components
7. CE marked and confirmed to be safe in accordance with EC New Approach Directives

## COMPONENTS:

- Fully assembled Ecosoft CE TWIN control valve (control valve, injector, DLFC, top distributor, AC transformer, funnel, user manual)
- Filter tank (with riser pipe and bottom distributor)
- Brine tank
- Filter media



*Anti-condensation tank cover is not included*

## IRON AND HARDNESS REDUCTION FILTERS ECOSOFT FK TWIN (ECOMIX® A)

Code	Q, m³/h (GPH) (nominal)	Volume of media, L (ft³)	Inlet/outlet size	List price, EUR
FK1054TWIN	1.3 (345)	75 (2.6)	1" NPT	2 590.00
FK1252TWIN	1.8 (475)	125 (4.4)		3 050.00
FK1354TWIN	2.2 (580)	125 (4.4)		3 380.00
FK1465TWIN	2.5 (660)	150 (5.3)		3 785.00
FK1665TWIN	3.3 (870)	200 (7.1)		4 485.00
FK2162TWIN	5.6 (1 480)	300 (10.6)	1.25" NPT	6 610.00

## CHLORINE REDUCTION FILTERS ECOSOFT FPA

### APPLICATION:

Water treatment for houses, hotels, cafes, restaurants, boilers, industrial processes

### FILTER MEDIA:

FILTRASORB® 300

### REDUCES:

Chlorine, toxic chlorination by-products, natural organic matter

### CONTROL VALVE:

Time controlled Ecosoft WS 1.0" CT / WS 1.25" CE (Clack Corporation, USA)

### KEY FEATURES:

1. Ready to use — fully equipped filter
2. Safe and colorless water — effective treatment of chlorine and chlorination by-products, improvement of water color and odor
2. Easy-to-use — advanced control valve Ecosoft CT/CE with quick and easy programming procedure
5. Reliable and long-term operation thanks to high-quality Clack Corporation components
6. CE marked and confirmed to be safe in accordance with EC New Approach Directives

### COMPONENTS:

- Fully assembled Ecosoft WS 1.0" CT / WS 1.25" CE control valve (control valve, DLFC, top distributor, AC transformer, funnel, user manual)
- Filter tank (with riser pipe and bottom distributor)
- Filter media



*Anti-condensation tank cover  
is not included*

### CHLORINE REDUCTION FILTERS ECOSOFT FPA (FILTRASORB® 300)

Code	Q, m³/h (GPH) (nominal)	Volume of media, kg (lb)	Inlet/outlet size	List price, EUR
FPA1054CT	0.60 (160)	25 (55)	1" NPT	995.00
FPA1252CT	0.85 (225)			1 080.00
FPA1354CT	1.0 (270)	50 (110)		1 510.00
FPA1465CT	1.2 (315)			1 595.00
FPA1665CT	1.55 (410)	75 (165)		2 050.00
FPA2162CE	2.65 (700)	100 (220)	1.25" NPT	3 500.00



# HYDROGEN SULFIDE REDUCTION FILTERS ECOSOFT FPC

## APPLICATION:

Well water treatment for houses, hotels, cafes, restaurants, industrial processes

## FILTER MEDIA:

Centaur®

## REDUCES:

Hydrogen sulfide ("rotten eggs" odor)

## CONTROL VALVE:

Time controlled Ecosoft WS 1.0" CT / WS 1.25" CE (Clack Corporation, USA)

## KEY FEATURES:

1. Ready to use — fully equipped filter
2. Odorless water — best solution for "rotten eggs" odor elimination
3. Easy-to-use — advanced control valve Ecosoft CT/CE with quick and easy programming procedure
4. Reliable and long-term operation thanks to high-quality Clack Corporation components
5. CE marked and confirmed to be safe in accordance with EC New Approach Directives

## COMPONENTS:

- Fully assembled Ecosoft WS 1.0" CT / WS 1.25" CE control valve (control valve, DLFC, top distributor, AC transformer, funnel, user manual)
- Filter tank (with riser pipe and bottom distributor)
- Filter media



*Anti-condensation tank cover  
is not included*

## HYDROGEN SULFIDE REDUCTION FILTERS ECOSOFT FPC (CENTAUR®)

Code	Q, m³/h (GPH) (nominal)	Volume of media, kg (lb)	Inlet/outlet size	List price, EUR
FPC1054CT	0.60 (160)	15 (33)	1" NPT	975.00
FPC1252CT	0.85 (225)	30 (66)		1 400.00
FPC1354CT	1.0 (270)			1 455.00
FPC1465CT	1.2 (315)	45 (99)		1 895.00
FPC1665CT	1.55 (410)	60 (132)		2 285.00
FPC2162CE	2.65 (700)	90 (200)	1.25" NPT	3 950.00

## SEDIMENT FILTERS ECOSOFT FP

### APPLICATION:

Water treatment for houses, hotels, cafes, restaurants, boilers, industrial processes

### FILTER MEDIA:

Filter Ag Plus®

### REDUCES:

Silt, sand, rust, scale (turbidity)

### CONTROL VALVE:

Time controlled Ecosoft WS 1.0" CT / WS 1.25" CE (Clack Corporation, USA)

### KEY FEATURES:

1. Ready to use — fully equipped filter
2. Transparent water — no mud or sand sediments on the surface of sanitary ware, longer service life of home appliances and heating systems
3. Easy-to-use — advanced control valve Ecosoft CT/CE with quick and easy programming procedure
5. Reliable and long-term operation thanks to high-quality Clack Corporation components
6. CE marked and confirmed to be safe in accordance with EC New Approach Directives

### COMPONENTS:

- Fully assembled Ecosoft WS 1.0" CT / WS 1.25" CE control valve (control valve, DLFC, top distributor, AC transformer, funnel, user manual)
- Filter tank (with riser pipe and bottom distributor)
- Filter media



*Anti-condensation tank cover  
is not included*

### SEDIMENT FILTERS ECOSOFT FP (FILTER-AG PLUS®)

Code	Q, m³/h (GPH) (nominal)	Volume of media, L (ft³)	Inlet/outlet size	List price, EUR
FP1054CT	0.60 (160)	28.3 (1.0)	1" NPT	710.00
FP1252CT	0.85 (225)	56.6 (2.0)		870.00
FP1354CT	1.0 (270)	84.9 (3.0)		925.00
FP1465CT	1.2 (315)	113.2 (4.0)		1 080.00
FP1665CT	1.55 (410)	169.8 (6.0)		1 230.00
FP2162CE	2.65 (700)		1.25" NPT	2 300.00

# CONTROL VALVES



WS 1" CE



WS 1" CI



WS 1" TC

Code Ecosoft / Code Clack Corp.	Description	List price, EUR
WS1CEDNMGR / V1CEDM	Control valve Clack WS 1" CE downflow regeneration metered control valve	640.00
WS1CIDNM / V1CIDM	Control valve Clack WS 1" CI downflow regeneration metered control valve	600.00
WS1TCDNT / V1TCBTZ	Control valve Clack WS 1" TC backwash only time controlled valve	400.00
WS125CIDNM / V125CIDM	Control valve Clack WS 125CI downflow regeneration metered control valve	750.00
WS15CIBWT / V15CIBTZ	Control valve Clack WS 15CI control valve backwash only time controlled valve	1 600.00
WS15CIDNM / V15CIDM	Control valve Clack WS 15CI downflow regeneration metered control valve	2 400.00
WS2CIBWT / V2CIBTZ	Control valve Clack WS 2CI backwash regeneration time controlled valve	2 350.00
WS2CIDNM / V2CIBTZ	Control valve Clack WS 2CI downflow regeneration metered control valve	3 200.00
WS3HDNT / V3BTZ	WS3 downflow regeneration time controlled valve	6 350.00

## CONTROL VALVE ACCESSORIES

Code Ecosoft / Code Clack Corp.	Description	List price, EUR
WS1AC22012 / V3186EU	Power Adaptor for Clack 220-240V-12V	30.00
WS1SPACER / V3005	WS1 Spacer stack assembly	60.00
WS1DRIVECA / V3004	WS1 Drive Cap	55.00
WS1PISTDN / V3011	WS1 Piston Downflow Assembly	17.00
WS1PISTUP / V3011-01	WS1 Piston Upflow Assembly	17.00
WS1PISTON / V3174	WS1 Regenerant Piston	12.00
WS1METER / V3003	WS1 Meter Assembly	100.00
DLFC-ZZZ / V3162-ZZZ*	WS1 DLFC for 3/4" drain line	2.85
DLFC1-YYY / V3190-YYY**	WS1 DLFC for 1" drain line	7.50
WS1ING-X / V3010-1X***	WS1 Injector Assembly	5.60
WS1REFPLUG / V3195-01	Clack valve refill port plug	8.20
WS1CLIP / H4615	Elbow Locking Clip	0.70
WS1WRENCH / V3193-02	WS1 service spanner wrench	17.00
WS1MICROSW / V3009	WS1 Auxiliary Microswitch Assembly	25.00
WS1FTG90NP / V3007	WS1 Ftg 1" PVC Male NPT Elbow Assembly	15.00
WS1FTG9NPT / V3007-04	WSI Ftg 1" Plastic Male NPT Assembly	22.50
WS1BYAD / V3191-01	Vertical 90° Adapter Kit	30.50
WS1FUNNEL / U1006	2.5" plastic funnel for pressure tank	5.00
TDIST287F / D1203	287F Top Stack Distributor 1.050	3.00
BDIST932 / D1236	932 BTM DIST 1.050 Bottom distributor	3.00
TDIST83011 / D1225-05	830F Top Stack Distributor 11 Segments 1.050	20.00
TDIST83014 / D1225-12	830F Top 14 Segments 32 mm	22.00
BDIST930 / D1212-23	930 BTM DIST 15SEG 32mm 010-013 Bottom distributor	13.00
WS1NBPAuto / V3070FM	WS1 & WS1.25 No Hard Water By-Pass Valve	285.00
WS1Bypass / V3006	WS1 Bypass Assembly	69.00

\* ZZZ = 0.7; 0.1; 1.3; 1.7; 2.2; 2.7; 3.2; 4.2; 5.3; 6.5; 7.5; 9.0; 10.0 GPM

\*\* YYY = 10.0; 11.0; 13.0; 15.0; 17.0; 20.0; 25.0 GPM

\*\*\* X = A, B, C, D, E, F, G, H, I, J, K, Z



## SOLUTIONS FOR HORECA

RObust filters are highly efficient reverse osmosis filters. Compact and light, they are intended to supply pure and safe drinking water for coffee, bars and restaurants.

Together with leading baristas we have created RObust PRO filter to obtain perfect drinking water and water for delicious coffee. RObust PRO purifies water, and enriches it with minerals, essential to open all the individual notes of coffee taste and odor.

To fulfill the requirements of pure drinking water supply for restaurants, hotels, breweries we designed high capacity RObust 3000 filter. RObust 3000 two times more powerful thanks to two reverse osmosis membranes instead of regular one. It is capable to provide uninterrupted drinking water supply to large number of people simultaneously.

# ECOSOFT ROBUST 1000 REVERSE OSMOSIS FILTER

## APPLICATION:

Cafes, restaurants, apartments, private houses

## FILTRATION TECHNOLOGY:

- Sediment PP 5-micron filter
- GAC coconut shell carbon filter
- DOW Filmtec™ RO membrane elements (3 pcs.)
- Coconut shell post-filter

## KEY FEATURES:

- Consistent high capacity
- Delicious water due to DOW Filmtec™ membrane elements and high-quality activated carbon filters
- Compact design
- Standard membranes and replacement filters
- Built-in indicators of pre-filters replacement control and filter operation
- Easy-to-use connections
- Dry-running pump protection function
- CE marked and confirmed to be safe in accordance with EC New Approach Directives



## SPECIFICATIONS:

Code	Flow capacity, LPH (GPH)	Water consumption, LPH (GPH)	Power supply	Power consumption, kW (hp)	Dimensions, H x W x D, mm (in)
ROBUSTEN	55–60 (15–16)	110–120 (29–32)	230 V, 50 Hz	0.08 (0.11)	420 × 425 × 220 (16.5 × 16.7 × 8.7)

## COMPONENTS:

- ROBust 1000 reverse osmosis filter
- Drinking water faucet
- Connection fittings pack
- Service wrenches
- User manual

## ECOSOFT ROBUST 1000 REVERSE OSMOSIS FILTER

Code*	Product	Membranes	List price, EUR	Pieces on pallet
ROBUSTECO	Ecosoft ROBust 1000 reverse osmosis filter (ECO)	3 x CSV-1812-100 (ECO)	620.00	24
ROBUSTEN	Ecosoft ROBust 1000 reverse osmosis filter (DOW)	3 x TW30-1812-100 (DOW)	700.00	24

## ROBUST 1000 REPLACEMENT COMPONENTS

Code	Product	List price, EUR
CHV3ECOEXP	Ecosoft set of improved replacement filters 1-2-3 for reverse osmosis filters*	13.00
TW1812100	DOW TW30-1812-100 GPD membrane element	70.00
CSV1812100ECO	Ecosoft CP-1812-100 GPD membrane element	38.00

\* see page 40 for more details

# ECOSOFT ROBUST 1500 REVERSE OSMOSIS FILTER

## APPLICATION:

Cafes, restaurants, apartments, private houses, pharmacies, laboratories

## FILTRATION TECHNOLOGY:

- Sediment PP 5-micron filter
- GAC coconut shell carbon filter
- DOW Filmtec™ RO membrane element
- Coconut shell post-filter

## KEY FEATURES:

- Consistent high capacity
- Designed for tankless operation
- Delicious water due to DOW Filmtec™ membrane element and high-quality activated carbon filters
- Dynamic SmartLight with illumination that displays the filter operation mode and signals about the filter's resources for their timely replacement
- Compact design
- Standard membrane and replacement filters
- Easy-to-use connections
- Dry-running pump protection function
- CE marked and confirmed to be safe in accordance with EC New Approach Directives



## SPECIFICATIONS:

Code	Flow capacity*, LPH (GPH)	Water consumption, LPH (GPH)	Power supply	Power consumption, kW (hp)	Dimensions, H x W x D, mm (in)
ROBUST1500	75–80 (20–21)	150–160 (40–42)	230 V, 50 Hz	0.08 (0.11)	420 × 425 × 265 (16.5 × 16.7 × 10.5)

\* At 25 °C feed water temperature, TDS 1000 mg/L

## COMPONENTS:

- ROburst 1500 reverse osmosis filter
- Drinking water faucet
- Connection fittings pack
- Service wrenches
- User manual

## ECOSOFT ROBUST 1500 REVERSE OSMOSIS FILTER

Code*	Product	Membrane	List price, EUR	Pieces on pallet
ROBUST1500	Ecosoft ROburst 1500 reverse osmosis filter	1 x TW30-3012-500 (DOW)	850.00	24

\* Please add «UK» to code for UK-plug (ROBUST1500ENUK) or «US» for US-plug (ROBUST1500ENUS)

## ROBUST 1500 REPLACEMENT FILTERS

Code	Product	List price, EUR
CHV3ECOEXP	Ecosoft set of replacement filters 1-2-3 for reverse osmosis filters*	13.00
TW3012500	DOW TW30-3012-500 GPD membrane element	300.00

\* see page 40 for more details



# ECOSOFT ROBUST PRO REVERSE OSMOSIS FILTER

## APPLICATION:

Coffee houses, cafes, restaurants

## FILTRATION TECHNOLOGY:

- Sediment PP 5-micron filter
- GAC coconut shell carbon filter
- DOW Filmtec™ RO membrane element
- Special ROBust PRO filter
- Coconut shell post-filter

## KEY FEATURES:

- Provides perfect water for coffee (in accordance with the SCAA standards)
- Scale prevention on heating elements of coffee machines
- Designed for tankless operation
- Balanced mineral composition of water
- Compact design
- Standard membrane and replacement filters
- Built-in indicators of pre-filters replacement control and filter operation
- Easy-to-use connections
- CE marked and confirmed to be safe in accordance with EC New Approach Directives
- Available in two color designs — brown and cream



## SPECIFICATIONS:

Code	Flow capacity*, LPH (GPH)	Water consumption, LPH (GPH)	Power supply	Power consumption, kW (hp)	Dimensions, H x W x D, mm (in)
ROBUSTPRO	70–75 (18–20)	140–150 (37–40)	230 V, 50 Hz	0.08 (0.11)	420 × 425 × 265 (16.5 × 16.7 × 10.5)

\* At 25 °C feed water temperature, TDS 1000 mg/L

## COMPONENTS:

- ROBust PRO reverse osmosis filter
- Drinking water faucet
- Connection fittings pack
- Service wrenches
- User manual

## ECOSOFT ROBUST PRO REVERSE OSMOSIS FILTER

Code*	Product	Membrane	List price, EUR	Pieces on pallet
ROBUSTPROW	Ecosoft ROBust PRO cream color	1 x TW30-3012-500 (DOW)	990.00	24
ROBUSTPROB	Ecosoft ROBust PRO brown color	1 x TW30-3012-500 (DOW)	990.00	24

\* Please add «UK» to code for UK-plug (e. g. ROBUSTPROWUK) or «US» for US-plug (e. g. ROBUSTPROWUS)

## ROBUST PRO REPLACEMENT FILTERS

Code	Product	List price, EUR
CHVROBUSTPRO	Ecosoft set of replacement filters 1-2-3-4 for reverse osmosis filter ROBust PRO	85.00
TW3012500	DOW TW30-3012-500 GPD membrane element	300.00

# ECOSOFT ROBUST 3000 REVERSE OSMOSIS FILTER

## APPLICATION:

Cafes, restaurants, water production, pharmacies, laboratories, small breweries, summer houses

## FILTRATION TECHNOLOGY:

- BB 10 GAC coconut shell carbon filter
- DOW Filmtec™ RO membrane elements (2 pcs.)
- BB 10 GAC coconut shell carbon filter

## KEY FEATURES:

- Consistent high capacity due to DOW Filmtec™ membrane elements
- Delicious water thanks to activated carbon filters
- High pressure pump
- Designed for tankless operation
- Compact design
- Standard membranes and replacement filters
- Built-in indicators of pre-filters replacement control and filter operation
- Easy-to-use connections
- Dry-running pump protection function
- CE marked and confirmed to be safe in accordance with EC New Approach Directives



## SPECIFICATIONS:

Code	Flow capacity*, LPH (GPH)	Water consumption, LPH (GPH)	Power supply	Power consumption, kW (hp)	Dimensions, H x W x D, mm (in)
ROBUST3000EN	145–150 (38–40)	290–300 (77–79)	230 V, 50 Hz	0.25 (0.34)	445 × 480 × 380 (17.5 × 18.9 × 15)

\* At 25 °C feed water temperature, TDS 1000 mg/L

## COMPONENTS:

- ROburst 3000 reverse osmosis filter
- Connection fittings pack
- Service wrenches
- User manual

## ECOSOFT ROBUST 3000 REVERSE OSMOSIS FILTER

Code	Product	Membrane	List price, EUR	Pieces on pallet
ROBUST3000EN	Ecosoft ROburst 3000 reverse osmosis filter	2 x TW30-3012-500 (DOW)	1 950.00	8

\* Please add «UK» to code for UK-plug (ROBUST3000ENUK) or «US» for US-plug (ROBUST3000ENUS)

## ROBURST 3000 REPLACEMENT FILTERS

Code	Product	List price, EUR
CHV4510ECOEXP	Ecosoft granular activated carbon replacement filter 4.5" × 10"	19.00
TW3012500	DOW TW30-3012-500 GPD membrane element	300.00



## ECOSOFT COMMERCIAL REVERSE OSMOSIS SYSTEMS

Ecosoft reverse osmosis systems are the reliable turnkey solutions for various commercial and residential applications. Water bottling plants, steam boilers, garden centers, restaurants and many other types of businesses take advantage of their excellent performance and durability.

Quality of our equipment is based on the vast field experience of our specialists combined with implementation of high-quality components and materials from the best global producers in the industry.

## ECOSOFT COMMERCIAL REVERSE OSMOSIS SYSTEM MO 6500

### APPLICATION:

Private houses, restaurants, laboratories,  
greenhouses, steam generators, carwashes, breweries, bakeries

### KEY FEATURES:

- Reliable performance due to high quality of engineering and components
- Saves up to 30% of space\* (4 pcs on a pallet)
- Easy-to-use thanks to smart architecture
- Saves up to 50% of energy\* due to DOW Filmtec™ XLE membranes and Grundfos pumps
- Original design
- CE marked and confirmed to be safe in accordance with EC New Approach Directives

\* As compared to previous models of Ecosoft RO systems

### KEY COMPONENTS:

- DOW Filmtec™ XLE-4040 membrane
- Grundfos high pressure pump
- Polypropylene sediment filter, 5-micron, 4.5"x10"
- Ecosoft controller
- Conductivity sensor
- European solenoid valves
- Praher and John Guest fittings/pipes
- Float switch, feed water and permeate pressure switches
- Wooden box packing



### ECOSOFT COMMERCIAL REVERSE OSMOSIS SYSTEM MO 6500

Code	Model	Dimensions, H x W x D, mm (in)	Membranes	Flow capacity**, LPH (GPH)	Pump	List price, EUR	Pieces on pallet
M6VCTFWE	MO 6500	1450 x 550 x 400 (57.1 x 21.7 x 15.8)	1/40 x 40	280 (75)	Horizontal multi-stage 0.67 kW/230V	4 390.00	4

\*\* At 25 °C feed water temperature, TDS 1000 mg/L

Maximum feed water TDS is 3000 mg/L

# ECOSOFT COMMERCIAL REVERSE OSMOSIS SYSTEM MO 12 000

## APPLICATION:

Private houses, restaurants, laboratories,  
greenhouses, steam generators, carwashes, breweries, bakeries

## KEY FEATURES:

- Reliable performance due to high quality of engineering and components
- Saves up to 30% of space\* (4 pcs on a pallet)
- Easy-to-use thanks to smart architecture
- Saves up to 50% of energy\* due to DOW Filmtec™ XLE membranes and Grundfos pumps
- Original design
- CE marked and confirmed to be safe in accordance with EC New Approach Directives

\* As compared to previous models of Ecosoft RO systems

## KEY COMPONENTS:

- DOW Filmtec™ XLE-4040 membrane
- Grundfos high pressure pump
- Polypropylene sediment filter, 5-micron, 4.5"x10"
- Ecosoft controller
- Conductivity sensor
- European solenoid valves
- Praher and John Guest fittings/pipes
- Float switch, raw water and permeate pressure switches
- Wooden box packing



## ECOSOFT COMMERCIAL REVERSE OSMOSIS SYSTEM MO 12 000

Code	Model	Dimensions, H x W x D, mm (in)	Membranes	Flow capacity**, LPH (GPH)	Pump	List price, EUR	Pieces on pallet
M10VCTFWE	MO 12000	1450 x 550 x 400 (57.1 x 21.7 x 15.8)	2/40 x 40	530 (140)	Horizontal multi-stage 0.67 kW/230V	5 600.00	4

\*\* At 25 °C feed water temperature, TDS 1000 mg/L

Maximum feed water TDS is 3000 mg/L

## ECOSOFT COMMERCIAL REVERSE OSMOSIS SYSTEM MO 24 000

### APPLICATION:

Breweries, pig farms, horse farms, beverages production plants, publishing houses, windows manufacturing, chemical producers, laboratories, greenhouses, steam generators etc.

### KEY FEATURES:

- Reliable performance due to high quality of engineering and components
- Saves up to 50% of space\*
- Easy-to-use thanks to smart architecture
- Saves up to 50% of energy\* — due to DOW Filmtec™ XLE membranes and Grundfos pumps
- Original design
- CE marked and confirmed to be safe in accordance with EC New Approach Directives

\* As compared to industrial models of Ecosoft RO

### KEY COMPONENTS:

- DOW Filmtec™ XLE-4040 membrane
- Grundfos high pressure pump
- Polypropylene sediment filter, 5-micron, 4.5"x20"
- Ecosoft controller
- Conductivity sensor
- European solenoid valves
- Praher and John Guest fittings/pipes
- Float switch, raw water and permeate pressure switches
- Wooden box packing



### ECOSOFT COMMERCIAL REVERSE OSMOSIS SYSTEM MO 24000

Code	Model	Dimensions, H x W x D, mm (in)	Membranes	Flow capacity**, LPH (GPH)	Pump	List price, EUR	Pieces on pallet
M24VCTFWE	MO 24000	1500 x 700 x 600 (590 x 27.6 x 23.6)	4/40 x 40	1 000 (265)	Horizontal multi-stage 1.9 kW/230V	9 000.00	1

\*\* At 25 °C feed water temperature, TDS 1000 mg/L

Maximum feed water TDS is 3000 mg/L



# ECOSOFT COMMERCIAL REVERSE OSMOSIS SYSTEM MO 36 000

## APPLICATION:

Breweries, pig farms, horse farms, beverages production plants, publishing houses, windows manufacturing, chemical producers, laboratories, greenhouses, steam generators etc.

## KEY FEATURES:

- Reliable performance due to high quality of engineering and components
- Saves up to 50% of space\*
- Easy-to-use thanks to smart architecture
- Saves up to 50% of energy\* due to DOW Filmtec™ XLE membranes and Grundfos pumps
- Original design
- CE marked and confirmed to be safe in accordance with EC New Approach Directives

\* As compared to industrial models of Ecosoft RO

## KEY COMPONENTS:

- DOW Filmtec™ XLE-4040 membrane
- Grundfos high pressure pump
- Polypropylene sediment filter, 5-micron, 4.5"x20"
- Ecosoft controller
- Conductivity sensor
- European solenoid valves
- Praher and John Guest fittings/pipes
- Float switch, raw water and permeate pressure switches
- Wooden box packing



## ECOSOFT COMMERCIAL REVERSE OSMOSIS SYSTEM MO 36 000

Code	Model	Dimensions, H x W x D, mm (in)	Membranes	Flow capacity**, LPH (GPH)	Pump	List price, EUR	Pieces on pallet
M36VCTFWE	MO 36000	1500 x 900 x 600 (59.0 x 27.6 x 23.6)	6/40 x 40	1 500 (396)	Horizontal multi-stage 1.9 kW/230V	11 700.00	1

\*\* At 25 °C feed water temperature, TDS 1000 mg/L

Maximum feed water TDS is 3000 mg/L

## ECOSOFT DOSING PUMP KITS

### APPLICATION:

Dosing of antiscalants, biocides, water solutions of chemical reagents for pH adjustment and reduction of water corrosive activity

### KEY FEATURES:

- Reliable and easy-to-use
- Adjustable injection frequency
- Protection against power surge and peak voltage
- Chemical resistance of the pump elements to aggressive substances

### KEY COMPONENTS:

- Dosing pump
- Foot filter with suction valve
- Injection valve
- Set of tubes for connection
- Reagent solution tank



### ECOSOFT DOSING PUMP KITS

Code	Product	Solution tank volume / impulse meter DN	List price, EUR
D100660	Dosing station, constant rate (0.1 - 1.0 L/hour)	60 L / —	695.00
D1006100		130 L / —	760.00
D03656025	Dosing station, proportional rate (0.1 - 7.0 L/hour)	60 L / DN 25	1 350.00
D036510025		130 L / DN 25	1 450.00



## ECOSOFT INDUSTRIAL REVERSE OSMOSIS SYSTEMS

We have been manufacturing wide range of reverse osmosis systems since 1999. Ecosoft provides turnkey solutions for industrial applications including pilot studies, system design, production, installation, start-up and maintenance. We have commissioned over 300 high-tech industrial projects.

Within our solutions, we employ world's leader DOW Chemical products, technologies and software. Ecosoft RO systems provide pure water for energetics, mechanical engineering, chemical, pharmaceutical, agricultural and many other industries.

# INDUSTRIAL REVERSE OSMOSIS SYSTEMS

## APPLICATION:

Steam generators, breweries, beverages producers, greenhouses, chemical factories



## OPTIONS:

- Reliable performance with high-quality components and professional engineering
- Energy saving and efficiency with DOW Filmtec™ XLE membranes and Grundfos Blueflux® pump
- Individual project evaluation for every case
- Flexible operation within wide range of conditions with adjustable flow rates
- CE marked and confirmed to be safe in accordance with EC New Approach Directives
- Manufacturing certified in accordance with ISO 9001:2008
- Produced since 1999

## KEY COMPONENTS:

- DOW Filmtec™ XLE-440 membrane elements
- Grundfos high pressure pump with Blueflux® technology
- Polypropylene sediment filters, 5-micron, 4.5"x20"
- Ecosoft controller
- Conductivity sensor
- European automated ball valves
- Praher and John Guest fittings/pipes
- Float switch, high pressure protection, raw water and permeate pressure switches
- Wooden box packing



## INDUSTRIAL REVERSE OSMOSIS SYSTEMS

Code	Product	Flow capacity, m³/h (GPH)	Membranes	Pump, V	List price, EUR	Options price, EUR	
						P*	I**
MO11XLWE	Ecosoft MO-1	1-1.2 (265-317)	1/80 x 40	Vertical multi-stage, 400	11 750.00	1 000	1 500
MO22XLWE	Ecosoft MO-2	2-3 (529-793)	2/80 x 40		17 750.00	1 000	1 500
MO33XLWE	Ecosoft MO-3	3-4 (793-1 057)	3/80 x 40		22 000.00	1 000	1 500
MO42XLWE	Ecosoft MO-4	4-5 (1 057-1 321)	4/80 x 40		26 000.00	1 000	1 500
MO62XLWE	Ecosoft MO-6	6-7 (1 585-1 850)	6/80 x 40		36 200.00	3 000	4 500
MO93XLWE	Ecosoft MO-9	9-11 (2 378-2 906)	9/80 x 40		43 600.00	3 000	4 500
MO12XLWE	Ecosoft MO-12	12-14 (3 170-3 699)	12/80 x 40		49 300.00	3 000	4 500
MO16XLWE	Ecosoft MO-16	16-19 (4 227-5 020)	16/80 x 40		65 800.00	5 000	7 000
MO20XLWE	Ecosoft MO-20	20-22 (5 284-5 812)	20/80 x 40		82 100.00	5 000	7 000
MO24XLWE	Ecosoft MO-24	24-26 (6 341-6 869)	24/80 x 40		98 450.00	5 000	7 000
MO30XLWE	Ecosoft MO-30	30-32 (7 926-8 454)	30/80 x 40		117 600.00	9 000	15 000
MO40XLWE	Ecosoft MO-40	40-44 (10 567-11 624)	40/80 x 40		156 700.00	9 000	15 000
MO50XLWE	Ecosoft MO-50	50-54 (13 209-14 266)	50/80 x 40		195 800.00	9 000	15 000

\* Reverse osmosis system with permeate rinsing

\*\*Reverse osmosis system with raw water blending

## RO MEMBRANES



Code	Product	List price, EUR
ULP4040	Ecosoft 4" ULP-4040	510.00
XLE4040	DOW Filmtec™ 4" XLE-4040	640.00
LCLE4040	DOW Filmtec™ 4" LCLE-4040	765.00
XLE440	DOW Filmtec™ 8" XLE-440	1 880.00
BW30400*	DOW Filmtec™ 8" BW30-400	1 790.00
BW30HRLE440*	DOW Filmtec™ 8" BW30HRLE-440	1 915.00
BW30XFRLE40034*	DOW Filmtec™ 8" BW30XFRLE-400/34	1 960.00
ECOPRO440*	DOW Filmtec™ 8" ECO PRO-440	2 250.00

\* Upon request. Delivery term up to 3 months

## CIP STATIONS FOR ECOSOFT MO SYSTEMS

Code/product	Description	List price, EUR
CIPSEP4	Ecosoft CIP station for 2.5", 4" membranes systems	2 900.00
CIPSEP	Ecosoft CIP station for 8" membranes systems	5 850.00

## ECOSOFT RO CHEMICALS

Code/product	Product	Description	List price, EUR*
ECOT100010	Ecotec RO 1000 (10 kg)	Antiscalant/dispersant	4.40
ECOT200010	Ecotec RO 2000 (10 kg)		5.33
ECOT300010	Ecotec RO 3000 (10 kg)		10.56
ECOT301010	Ecotec RO 3010 (10 kg)	Antiscalant/dispersant (against iron species)	11.91
ECDB510	Ecocide DB5 (10 kg)	Biocide	10.56
ECDB2010	Ecocide DB20 (10 kg)		14.16

\* The price is indicated for 1 kg



## ECOSOFT UV DISINFECTION UNITS

### APPLICATION:

Disinfection of the water in private houses, hotels, restaurants, water production units and vending machines. Can be used as an integral stage within water purification plants and for various industrial processes

### KEY FEATURES:

- Large dose of UV irradiation (30 mJ/cm<sup>2</sup>) sufficient to neutralize a wide spectrum of microorganisms
- Physical method of disinfection that does not require additional reagents or generates any toxic by-products
- Chamber made of stainless steel by AISI 304
- The sleeve is made of high-purity quartz, and is extra-resistant to formation of deposits or erosion
- Long efficient service life – up to 9 000 hours

### COMPONENTS:

- Assembled stainless steel chamber
- Quartz sleeve
- UV lamp
- Power adapter (electronic ballast)



### ECOSOFT UV DISINFECTION UNITS

Code	Description	Flow capacity, m <sup>3</sup> /h (GPH)	Inlet/outlet size	List price, EUR
HR60	ECOSOFT UV HR-60	0.23 (60)	1" NPT	122.00
E360	ECOSOFT UV E-360	1.36 (360)		350.00
E480	ECOSOFT UV E-480	1.81 (480)		455.00
E720	ECOSOFT UV E-720	2.72 (720)		570.00
ET24	ECOSOFT UV ET-24	5.44 (1 440)	1.5" NPT	1 540.00
EB45	ECOSOFT UV EB-45 (2 lamps)	10.20 (2 700)	2" NPT	2 150.00

### REPLACEMENT PARTS

Code	Description	List price, EUR
HR60UV	T510 lamp for ECOSOFT UV HR-60	27.70
E360UV	T521 lamp for ECOSOFT UV E-360	36.85
E480UV	T529 lamp for ECOSOFT UV E-480	58.50
E720UV	T540 lamp for ECOSOFT UV E-720	74.40
ET24UV	T585 lamp for ECOSOFT UV ET-24/ EB-45	103.00
HR60EB	Electronic ballast for ECOSOFT UV HR-60	60.00
E360720	Electronic ballast for ECOSOFT UV E-360/480/720	175.00
E24EB	Electronic ballast for ECOSOFT UV ET-24	200.00
HR60QS	Quartz sleeve for ECOSOFT UV HR-60 (250 mm)	12.40
E360QS	Quartz sleeve for ECOSOFT UV E-360 (530 mm)	23.40
E480QS	Quartz sleeve for ECOSOFT UV E-480 (680 mm)	33.00
E720QS	Quartz sleeve for ECOSOFT UV E-720/ ET-24/ EB-45 (910 mm)	38.00



## ECOSOFT INDUSTRIAL ULTRAFILTRATION SYSTEMS

Ecosoft industrial ultrafiltration systems are widely used for water pre-treatment before reverse osmosis systems and for ultra-fine drinking water treatment for reduction of sediments and colloidal particles with a filtration range of up to 0.03 microns.

Ecosoft systems are equipped with high-performance DOW™ Ultrafiltration elements SFP-2860-XP based on the advanced XP ultrafiltration fiber, which allows the consumer to obtain 35% purer water in comparison with analogues.

Ecosoft ultrafiltration systems are equipped with a hydraulic and chemical backwash blocks (BW&CEB) for convenient operation and can be equipped with a CIP station as an option.



## COMMERCIAL ULTRAFILTRATION SYSTEMS

### APPLICATION:

RO pre-treatment, extra-fine sediment and colloids filtration

### KEY COMPONENTS:

- UF Skid with DOW™ Ultrafiltration SFP-2860XP elements
- BW&CEB station with BW-pump, dosing-pump stations, air compressor
- UNITRONICS controller with colour LCD
- 200 mc sediment prefilter
- Electro-magnetic flowmeter
- European electric ball valves
- Raw water and permeate pressure switches and gauges
- European PVC and John Guest fittings/pipes
- Ports for CIP



### COMMERCIAL ULTRAFILTRATION SYSTEMS

Code	Product	Membranes	Filtration area, m <sup>2</sup>	List price, EUR
UFBWCEB02	02UF Skid-BW&CEB station	2	102	58 500.00
UFBWCEB04	04UF Skid-BW&CEB station	4	204	75 600.00
UFBWCEB06	06UF Skid-BW&CEB station	6	306	103 800.00
UFBWCEB08	08UF Skid-BW&CEB station	8	408	125 00.00

### OPTIONS FOR ULTRAFILTRATION SYSTEMS

Code	Product	List price, EUR
LSEm	Level switch	175.00
TMEem	Turbidimetr	7 850.00
PHMEem	pH-meter	1 600.00
RHMEem	RH-meter	1 600.00
FP	Feed pump	upon request
PT	Permeate tank	upon request

### CIP STATION WITH HEATER FOR ULTRAFILTRATION SYSTEMS

Code	Product	List price, EUR
CIPUF0204	CIP-station for UFBWCEB02-04	10 500.00
CIPUF0608	CIP-station for UFBWCEB06-08	12 150.00



## ECOSOFT CONTAINER RO SYSTEMS

Ecosoft modular water treatment stations are based on standard 20 ft and 40 ft transport containers.

Ecosoft containers are equipped with the most advanced reverse osmosis technology on the basis of DOW Filmtec™ membrane elements. Having communications ready on site you can obtain a quick turnkey mobile station for high-quality water treatment for household, drinking and technological needs.

Ecosoft water treatment stations are widely used to provide people with high-quality drinking water in places of temporary settlement, on the territory of mining and processing plants, for irrigation in agriculture and nutrition of the drip irrigation system in hothouse facilities, as well as in energetics for water pre-treatment.

Modular stations are all-weather and heat-insulated, equipped with air conditioning, heating system, and are designed for operation in seismically active regions.

## ECOSOFT CONTAINER RO SYSTEMS

### APPLICATION:

Utility and drinking water for temporary industrial settlements, product water for boilers and steam generators, agriculture



### KEY FEATURES:

- Individual approach to development of water purification technology
- Reduction of capital costs for premises construction and communications
- Quick installation and commission of equipment at the location
- In the case of seasonal application, the equipment can be easily mothballed and transported to the warehouse

### KEY COMPONENTS:

- Sediment disk filter Arkal 130 micron
- NaClO dosing station
- Multimedia Ecosoft-FP with Filter AG Plus media
- Sodium sulfite dosing station
- Antiscalant dosing station
- Biocide/caustic dosing station
- Reverse osmosis systems Ecosoft MO-3/6/9/12 with permeate fast rinse feature
- PP permeate tank 5-10 m<sup>3</sup>
- Treated water Grundfos pump with frequency controller
- UV-disinfection system
- PVC (Praher/GF) and John Guest fittings and pipes
- Heat-insulated container 20/40 ft with air heating and cooling system

### ECOSOFT CONTAINER RO SYSTEMS

Model	Product	Flow capacity, m <sup>3</sup> /h (GPH)	Size	List price, EUR
KFPMO3	Ecosoft Module KFPMO-3	3.0 (795)	Container 20 ft	71 500.00
KFPMO6	Ecosoft Module KFPMO-6	6.0 (1 590)	Container 20 ft	95 300.00
KFPMO9	Ecosoft Module KFPMO-9	9.0 (2 385)	Container 40 ft HC	132 300.00
KFPMO12	Ecosoft Module KFPMO-12	12.0 (3 180)	Container 40 ft HC	149 550.00

# ECOSOFT RO DRINKING WATER VENDING MACHINES

Ecosoft water vending machine is a turnkey business which can be set up in a couple of weeks. Find hightraffic locations in shopping centers, supermarkets or residential areas to supply high quality drinking water for cafes, restaurants and thousands of households.

Manage your vending machines via special web-interface: check the virtual dashboard to control revenue, technical condition, chemicals consumption and create managerial reports in one click.

## ECOSOFT RO DRINKING WATER VENDING MACHINES

### APPLICATION:

Vending machine is intended for purification and pouring of water into consumer bottles

### KEY FEATURES:

- Independency — the machine gains profit 24/7 and does not require constant control
- High profitability — the cost of 1 liter of water is 3 times lower than alternatives
- Stable efficiency of the operation provided by the DOW Filmtec™ membranes (USA)
- Remote control — GSM/GPRS module provides monitoring by Internet
- Anti-vandal protection — housing made of durable material and shock-resistant control panel
- Compact — the minimum rent required, since only 1 m<sup>2</sup> of space is sufficient for the machine
- Quality guarantee confirmed by international CE and ISO certificates

### MAIN COMPONENTS (BASIC CONFIGURATION):

- Metal housing
- Assembled water purification system
- Controller with integrated GSM/GPRS module
- Pouring terminal
- Antiscalant dosing unit (for KA-250 only)



### ECOSOFT RO DRINKING WATER VENDING MACHINES

Code	Product	Capacity	Clean water tank volume, L (gal)	Power supply	Dimensions, H x W x D, mm (in)	List price, EUR
KA250RO	KA-250 basic configuration	6 000	60 (16)	230V, 50 Hz	1900 x 750 x 850 (74.8 x 29.5 x 33.5)	11 750.00
KA60RO	KA-60 basic configuration	1 440	200 (53)			8 750.00

### OPTIONS

	List Price, EUR
Bill receptor	975.00
Coin receptor	475.00
Pressurized drainage pump	300.00
Mineral dosing station	950.00
LED display	475.00
Temperature maintenance	625.00



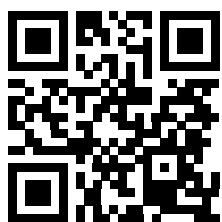

[ecosoft.com](https://ecosoft.com)